



CADERNO DE DETALHAMENTO SESC GURUPI

 ODONTOLOGIA

Setor: Obras

Supervisora: Beatriz Senna

Projetista: Alanna Ferreira

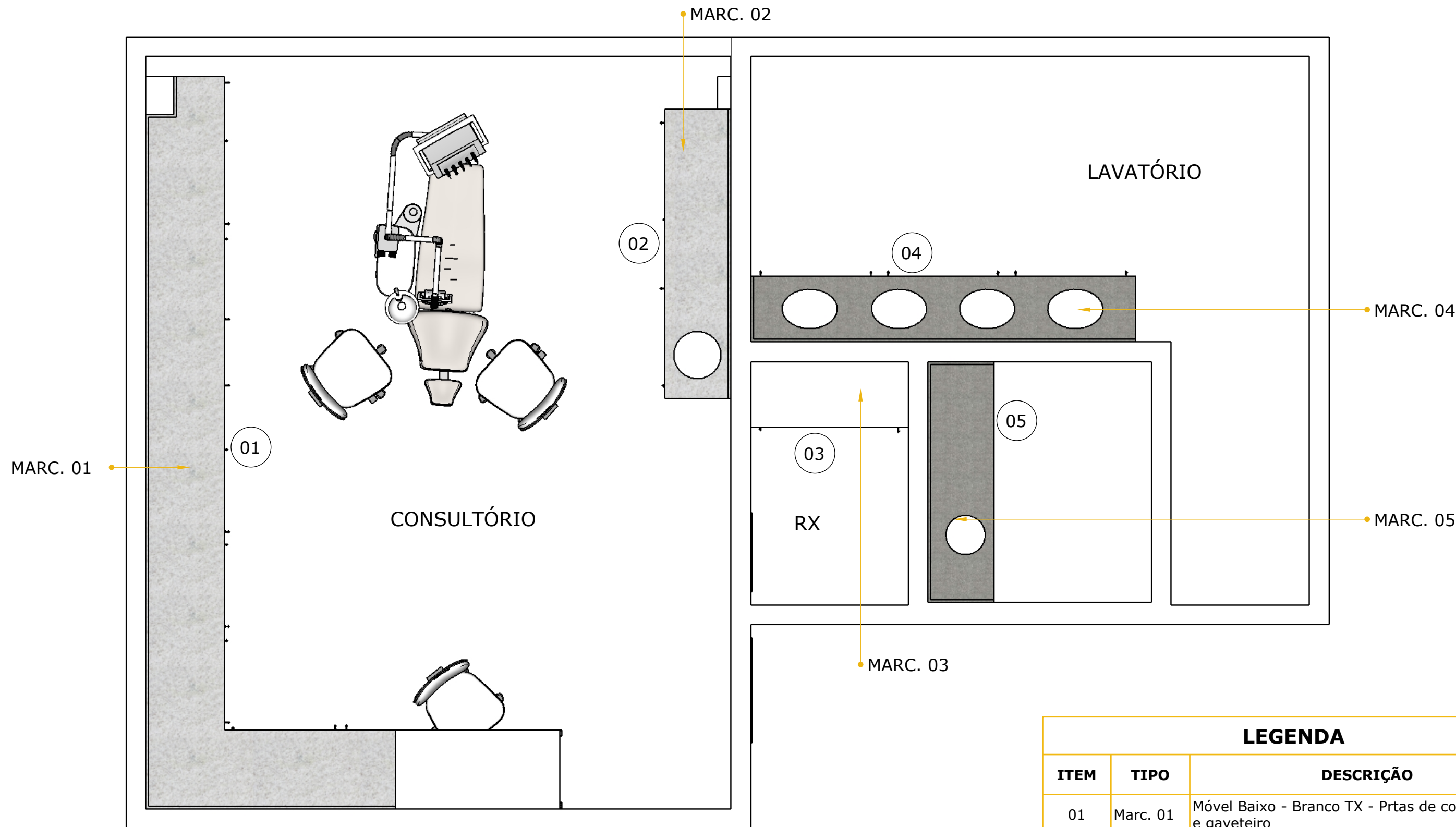

01 PLANTA DE LAYOUT
Esc. 1:30

OBS. Todo Móvel em MDF Ultra
Conferir Medidas IN LOCO

LEGENDA		
ITEM	TIPO	DESCRIÇÃO
01	Marc. 01	Móvel Baixo - Branco TX - Prtas de correr, lixeira e gaveteiro
02	Marc. 02	Móvel Baixo - Branco TX - Portas de correr + Lixeira
03	Marc. 03	Móvel Baixo - Branco TX - Portas de correr
04	Marc. 04	Móvel Baixo - Branco TX - Portas de correr
05	Marc. 05	Móvel Suspenso - Branco TX - Portas de correr

Cód.: AIC1

Corpo: 25mm

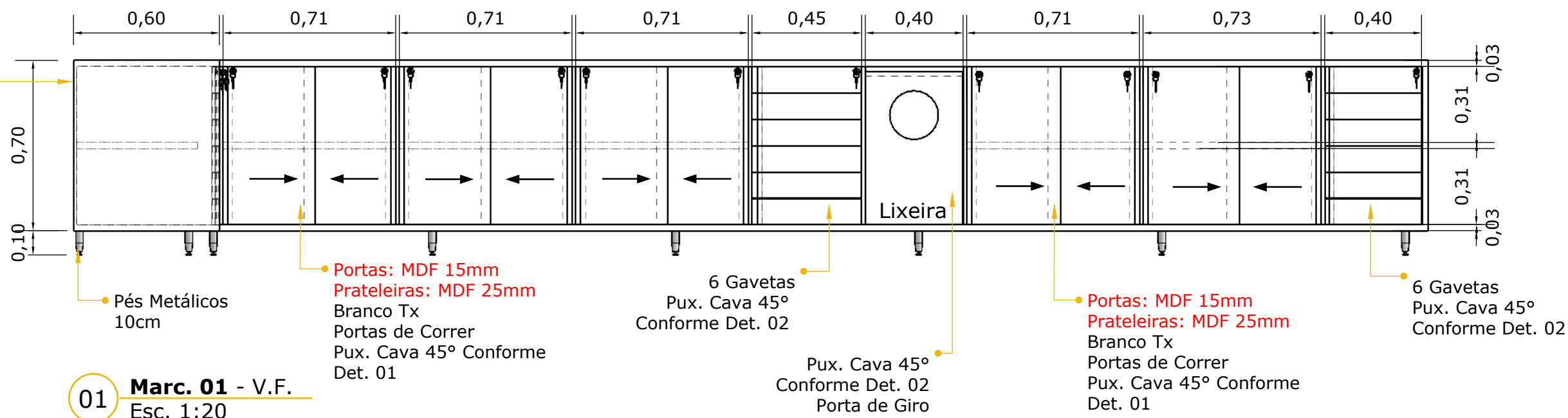

01 Marc. 01 - V.F.
Esc. 1:20

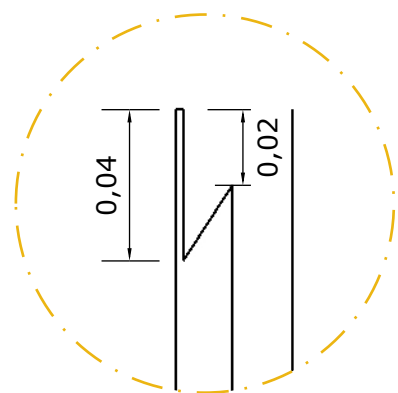

Det. 01 - Vista Superior
Cava 45° - Vertical
Esc. 1:2

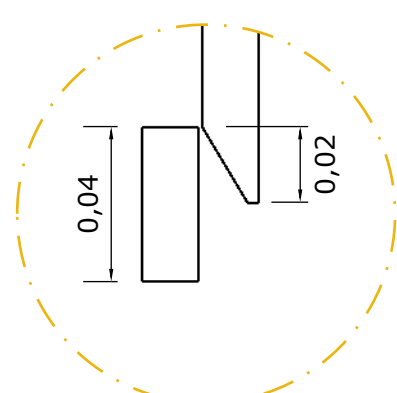

Det. 02 - Vista Superior
Cava 45° - Vertical
Esc. 1:2

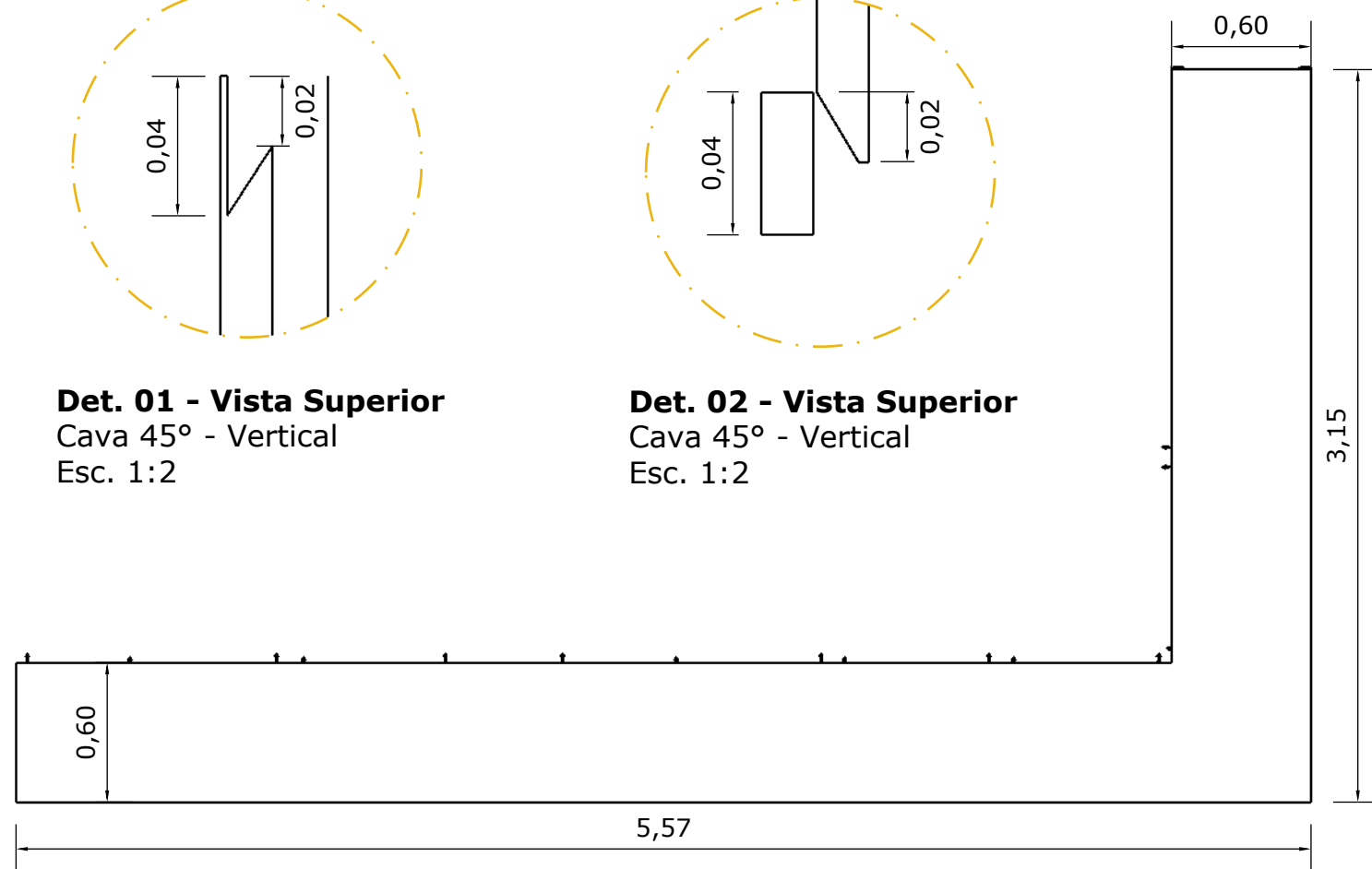

03 Marc. 01 - V.S.
Esc. 1:30

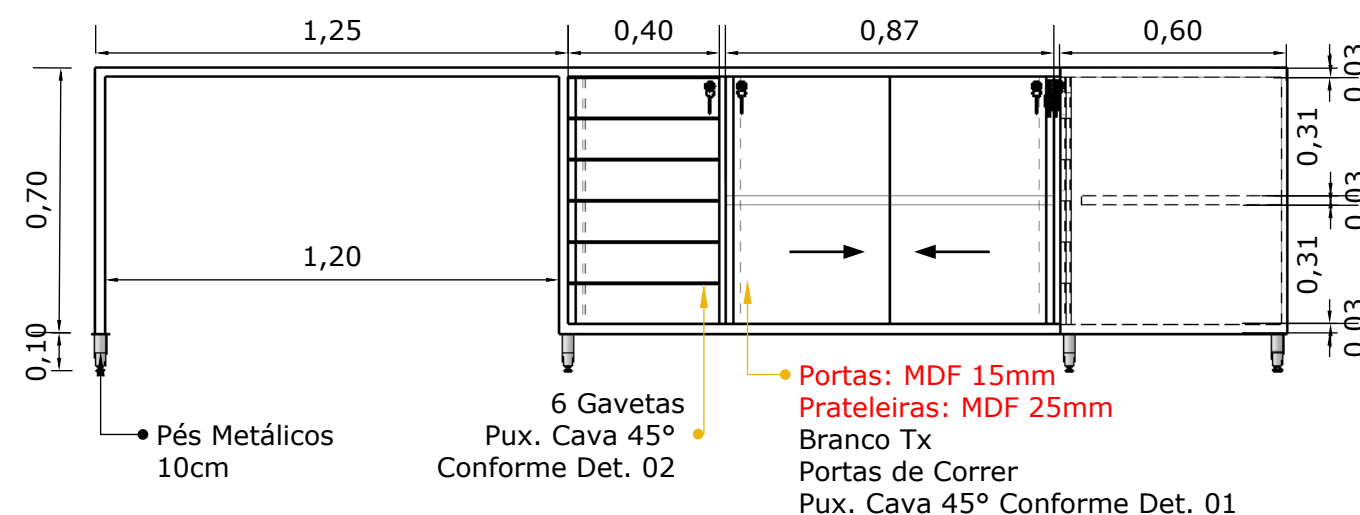

02 Marc. 01 - V.L.
Esc. 1:20

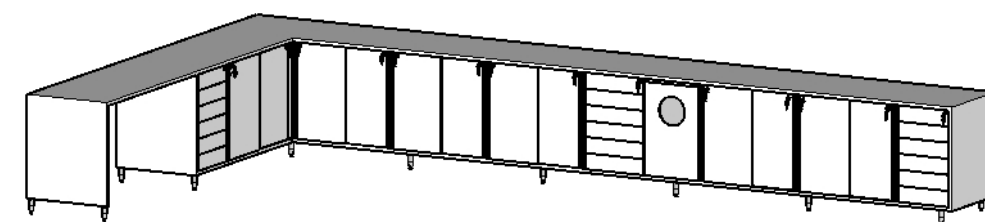

OBS. Todo Móvel em MDF Ultra
Conferir Medidas IN LOCO

OBS. Todas as portas com fechadura



Projeto de Interiores
Detalhamento de móvel

Desenho: Alanna Ferreira
Data: 7, dezembro 2022

Supervisora: Beatriz
Engenheira

Projeto:
ODONTOLOGIA

Revisão:
Rev. 00

2/14

Cód.: AIC2

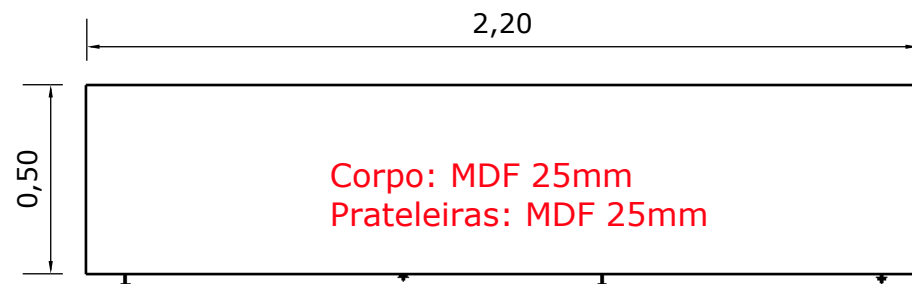

Cód.: AIR1

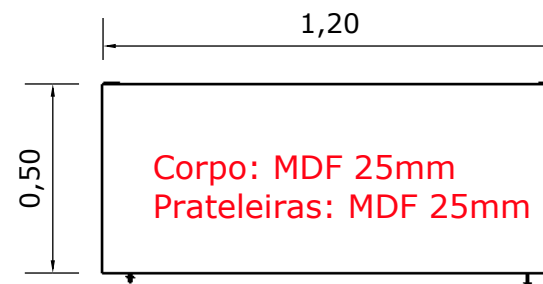

Cód.: AIE1

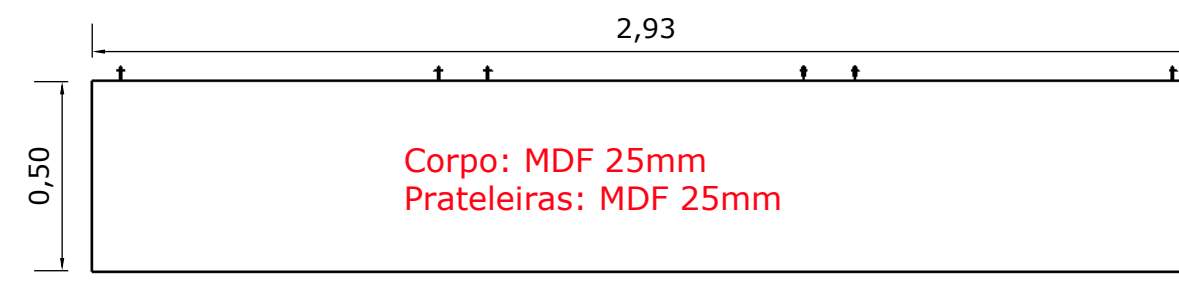

01 Marc. 02 - V.S.
Esc. 1:20

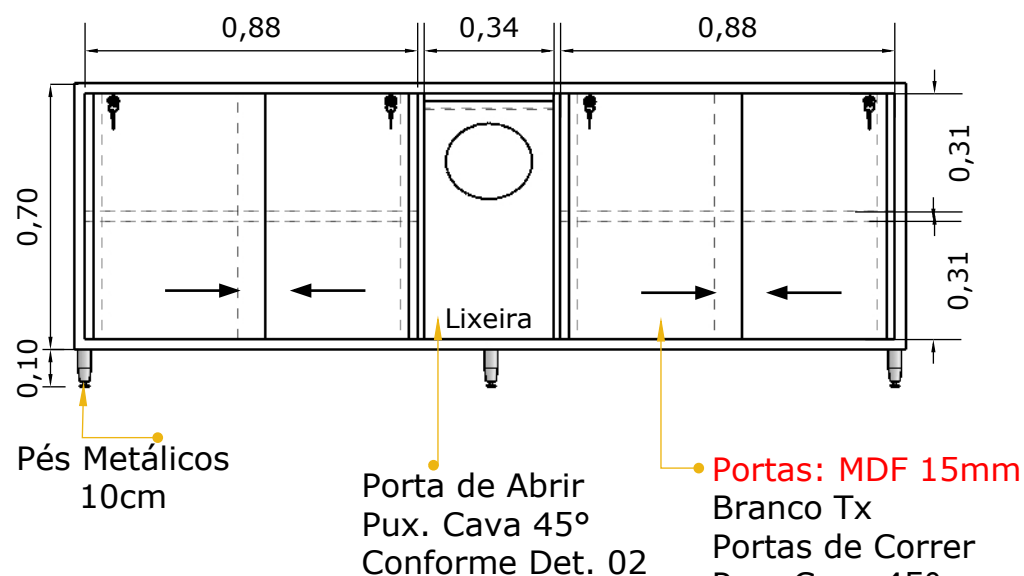

03 Marc. 03 - V.S.
Esc. 1:20

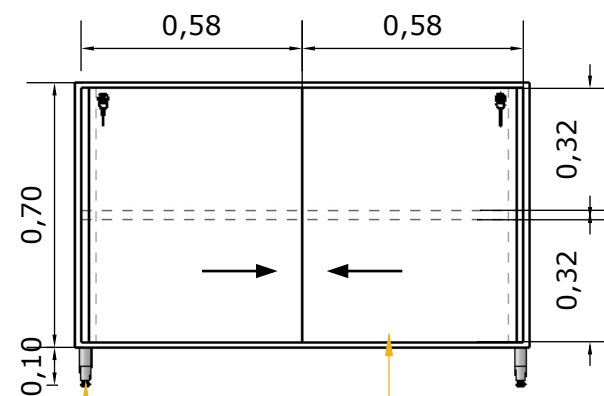

05 Marc. 04 - V.S.
Esc. 1:20

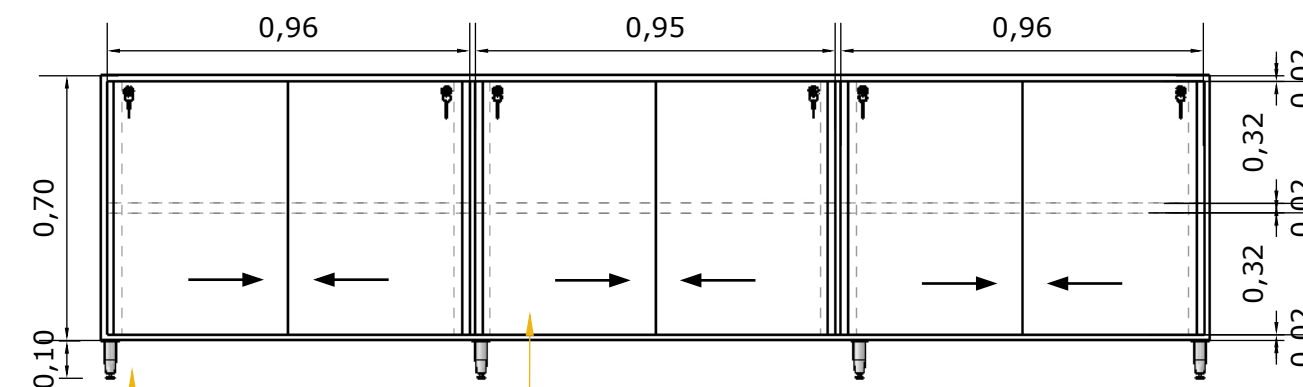

02 Marc. 02 - V.F.
Esc. 1:20

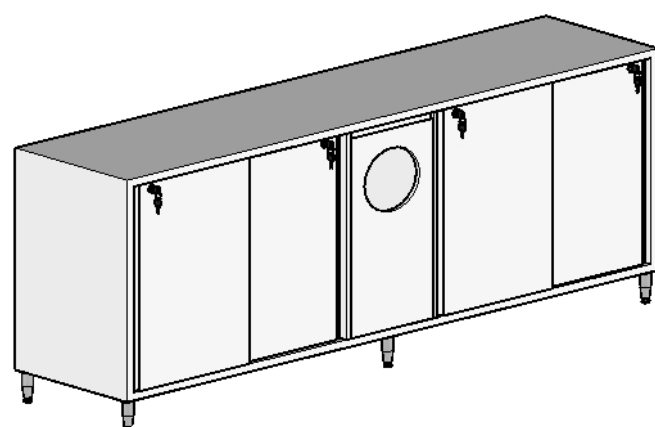

04 Marc. 03 - V.F.
Esc. 1:20

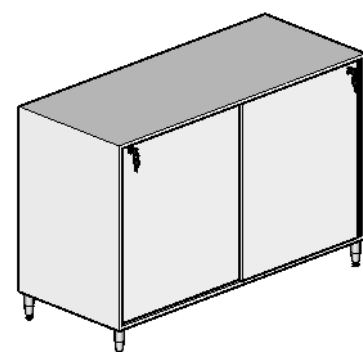

06 Marc. 04 - V.F.
Esc. 1:20

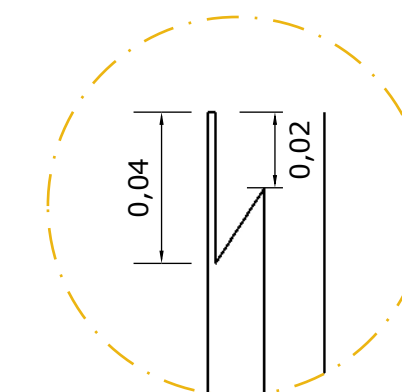
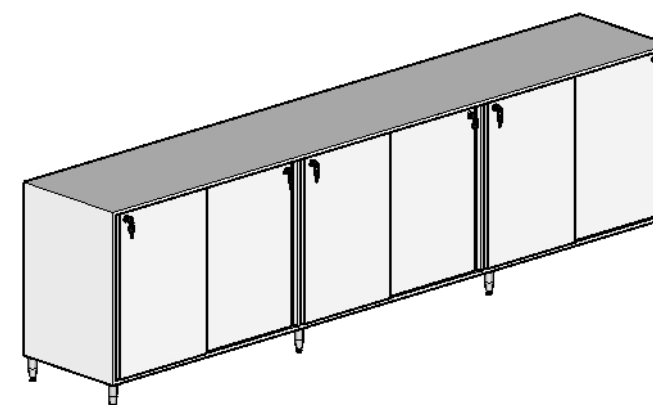

Det. 01 - Vista Superior
Cava 45° - Vertical
Esc. 1:2

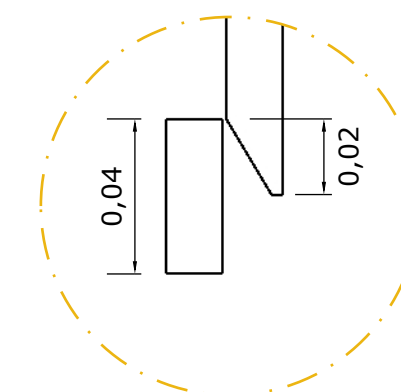

Det. 02 - Vista Superior
Cava 45° - Vertical
Esc. 1:2

07 Isométrico
Esc. S/E

OBS. Todo Móvel em MDF Ultra
Conferir Medidas IN LOCO

OBS. Todas as portas com fechadura

Cód.: AIW1

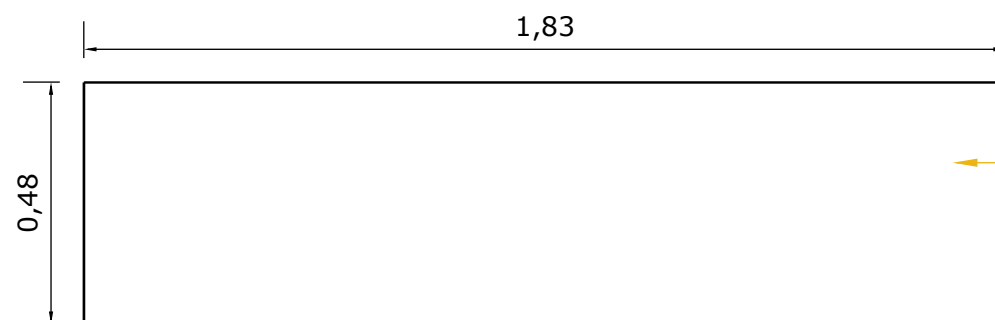

Corpo: MDF 25mm
Prateleiras: MDF 15mm
Frentes: MDF 15mm

01 Marc. 05 - V.S.
Esc. 1:15

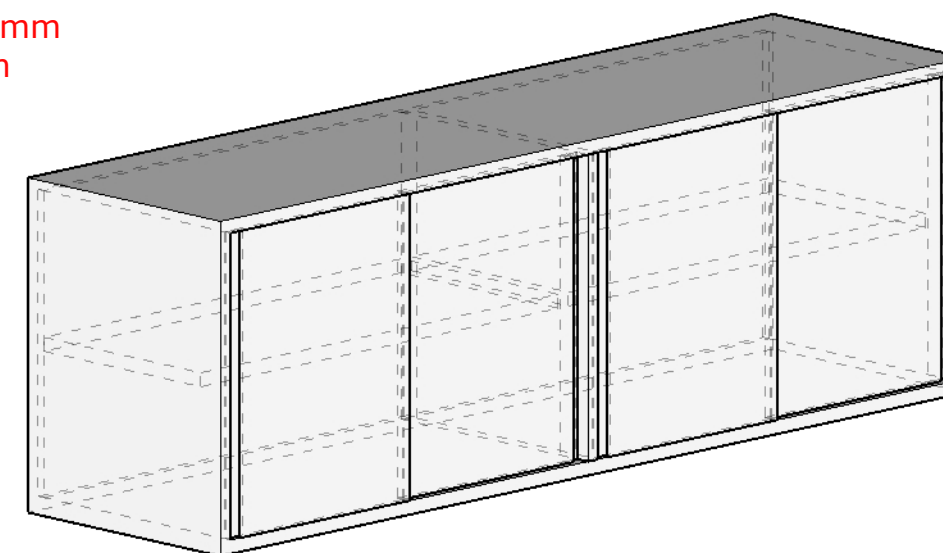

03 Isométrico
Esc. S/E

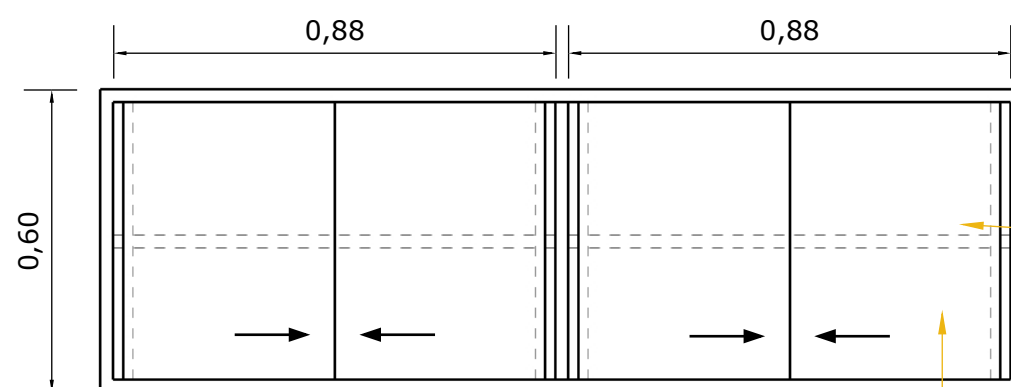

1 Prateleira interna

Frentes: MDF 15mm
Branco Tx
Portas de Correr
Pux. Cava 45°
Conforme Det. 01

02 Marc. 05 - V.F.
Esc. 1:15

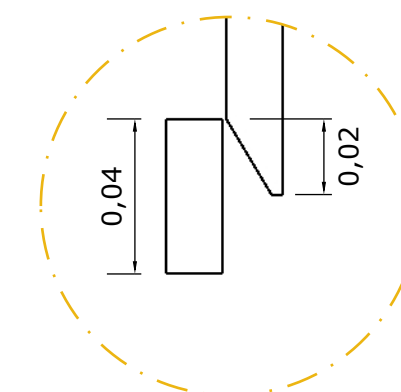

Det. 02 - Vista Superior
Cava 45° - Vertical
Esc. 1:2

OBS. Todo Móvel em MDF Ultra
Conferir Medidas IN LOCO

OBS. Todas as portas com fechadura



Projeto de Interiores
Detalhamento de móvel

Desenho: Alanna Ferreira
Data: 7, dezembro 2022

Supervisora: Beatriz
Engenheira

Projeto:
ODONTOLOGIA

Revisão:
Rev. 00

4/14

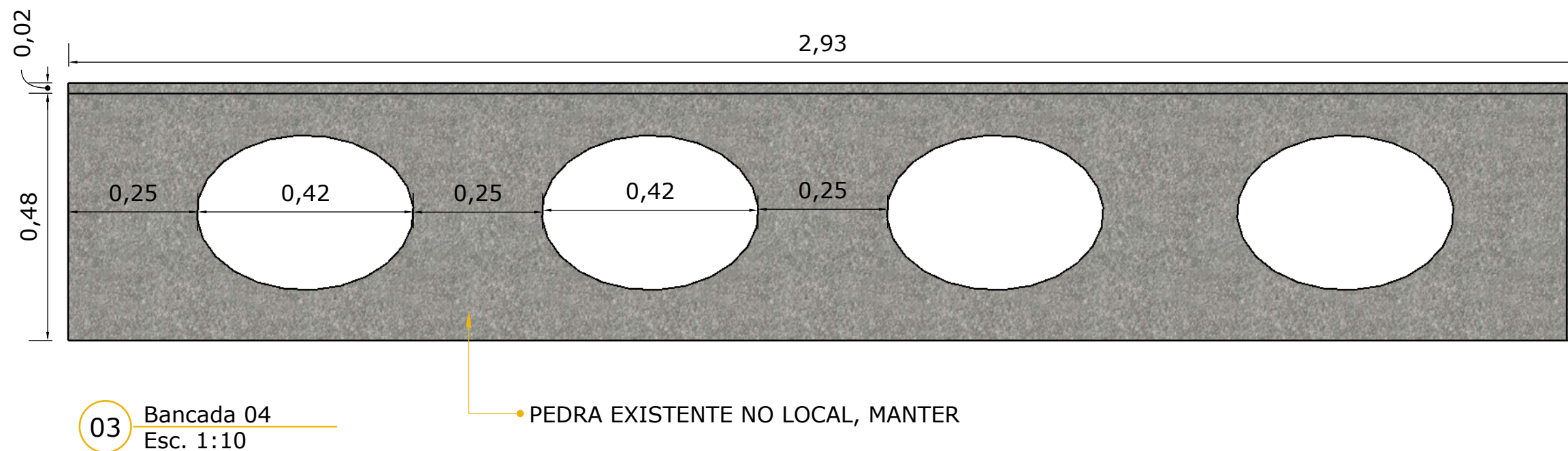
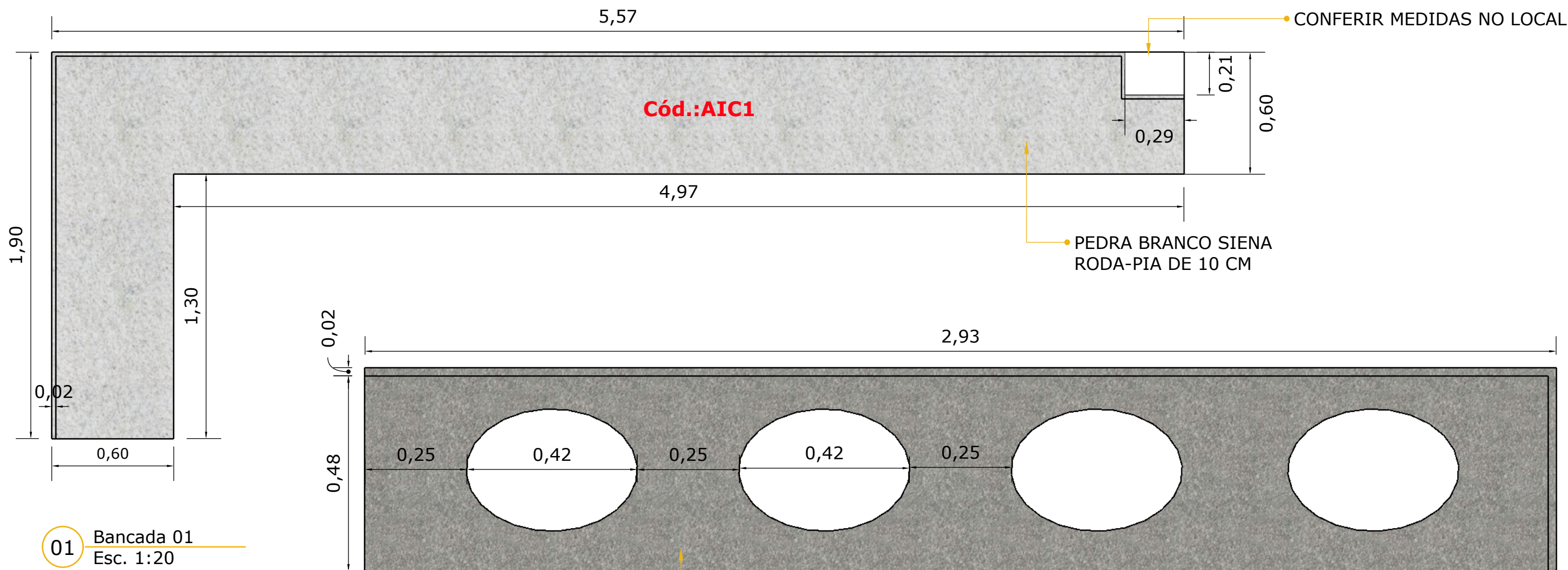

FAZER RECORTE DA CUBA,
SOMENTE MEDIANTE MATERIAL NO LOCAL

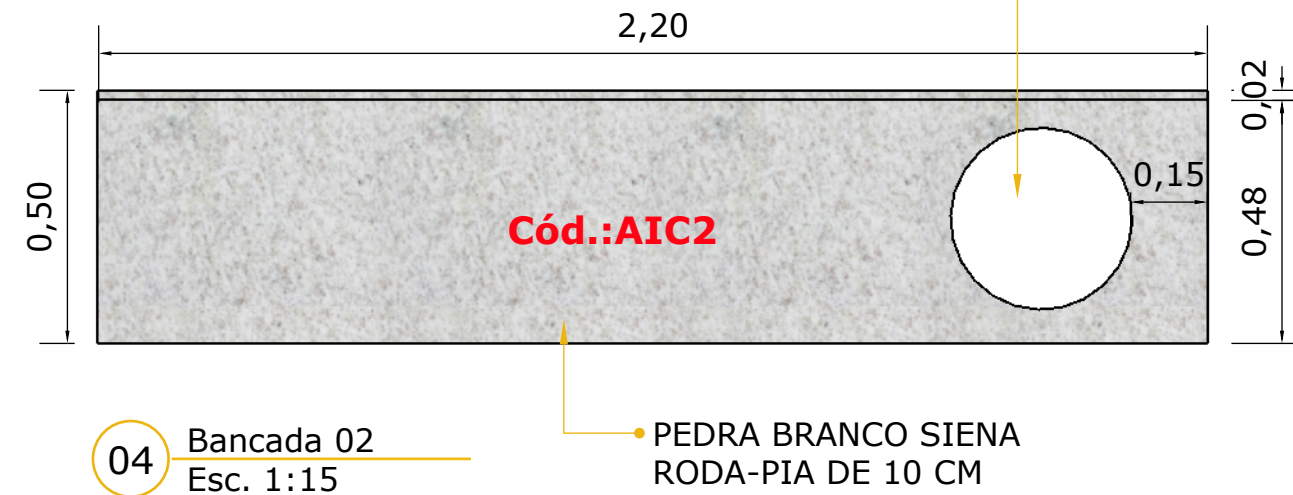
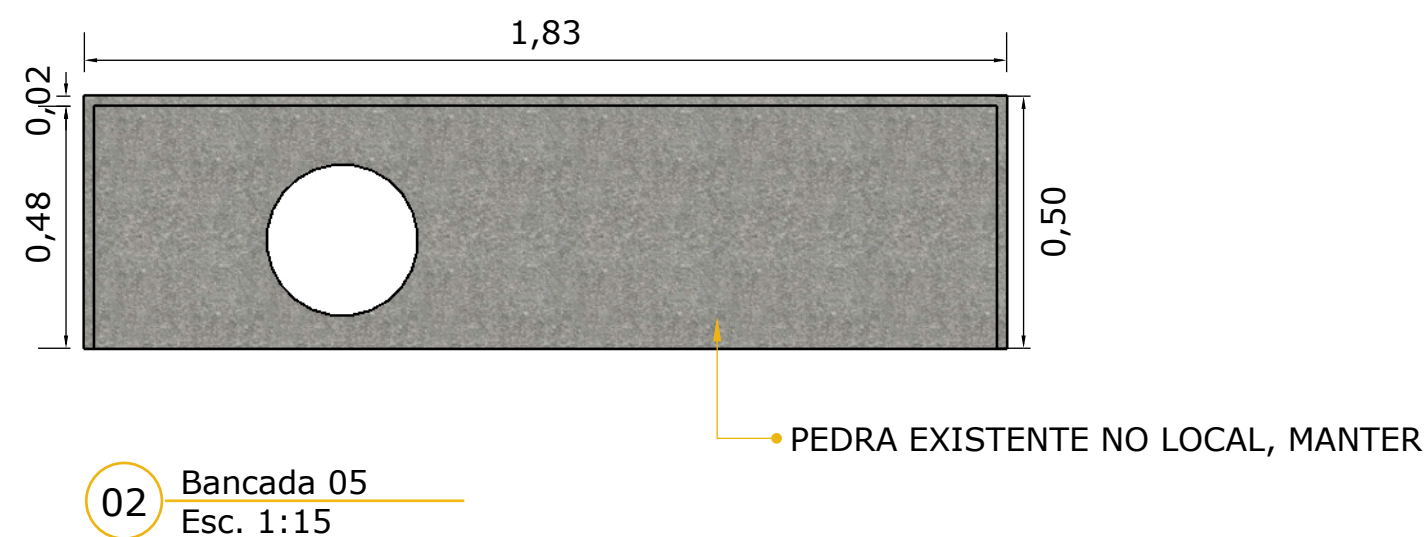

OBS. Todo Móvel em MDF Ultra
Conferir Medidas IN LOCO

Obs. Todas as pedras no Granito Branco Siena, com espessura de 0,05 cm

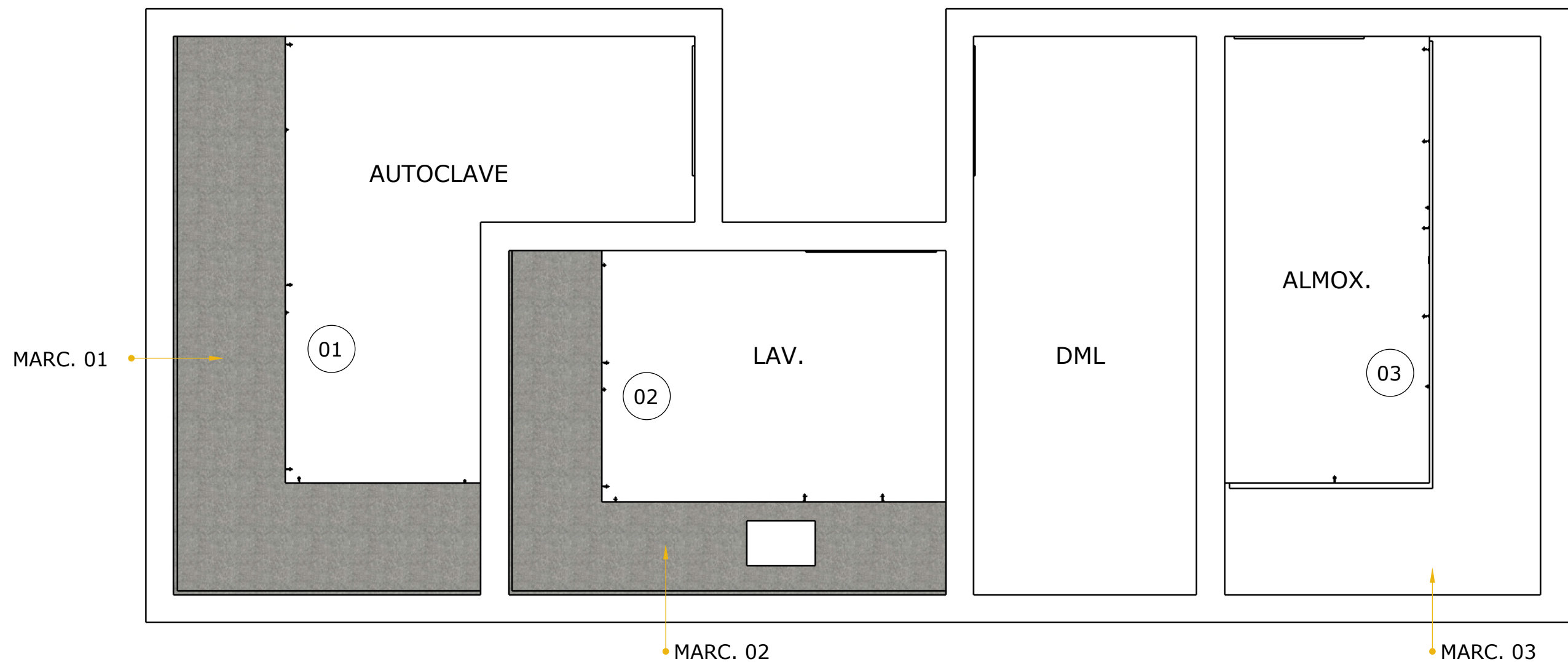

01 PLANTA DE LAYOUT
Esc. 1:25

OBS. Todo Móvel em MDF Ultra
Conferir Medidas IN LOCO

LEGENDA		
ITEM	TIPO	DESCRIÇÃO
01	Marc. 01	Móvel Baixo - Branco TX - Prtas de correr e gaveteiro
02	Marc. 02	Móvel Baixo - Branco TX - Portas de correr, lixeira e gavetas
03	Marc. 03	Móvel Baixo - Branco TX - Portas de correr

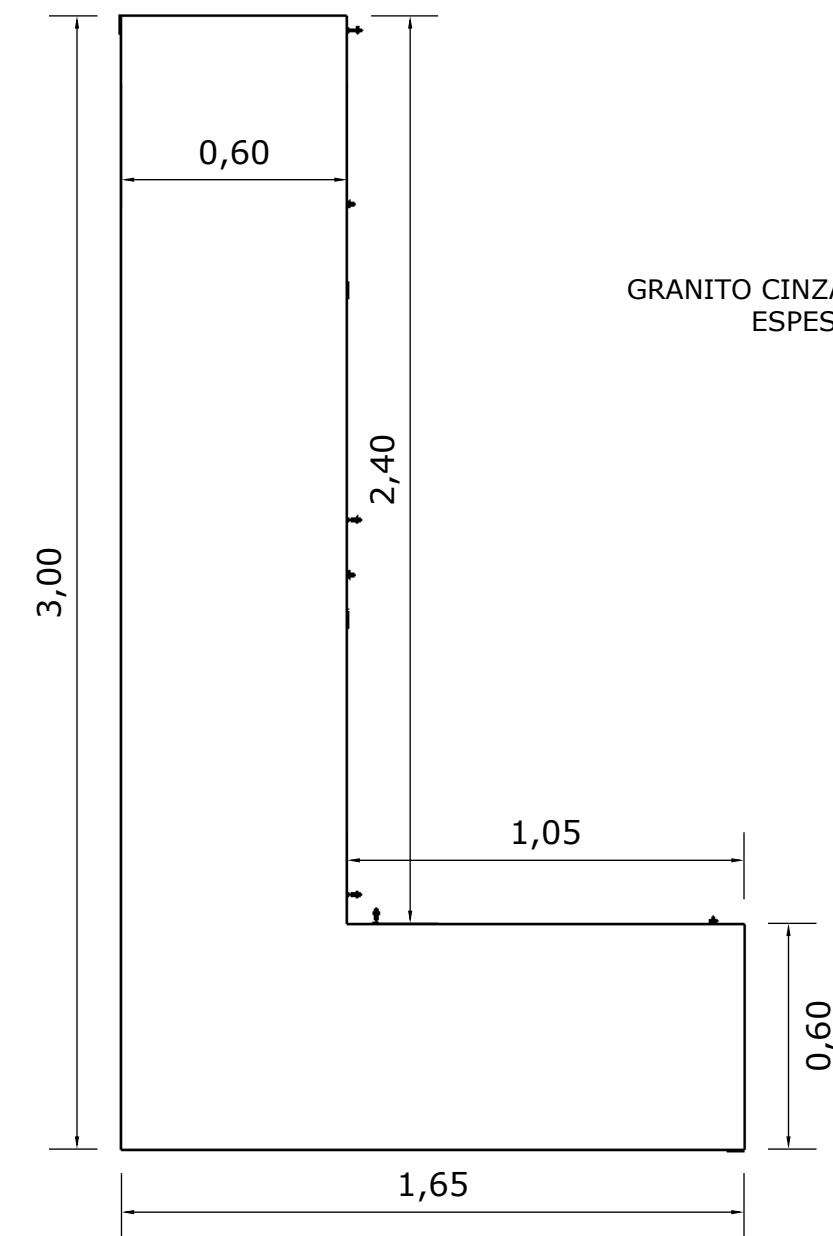
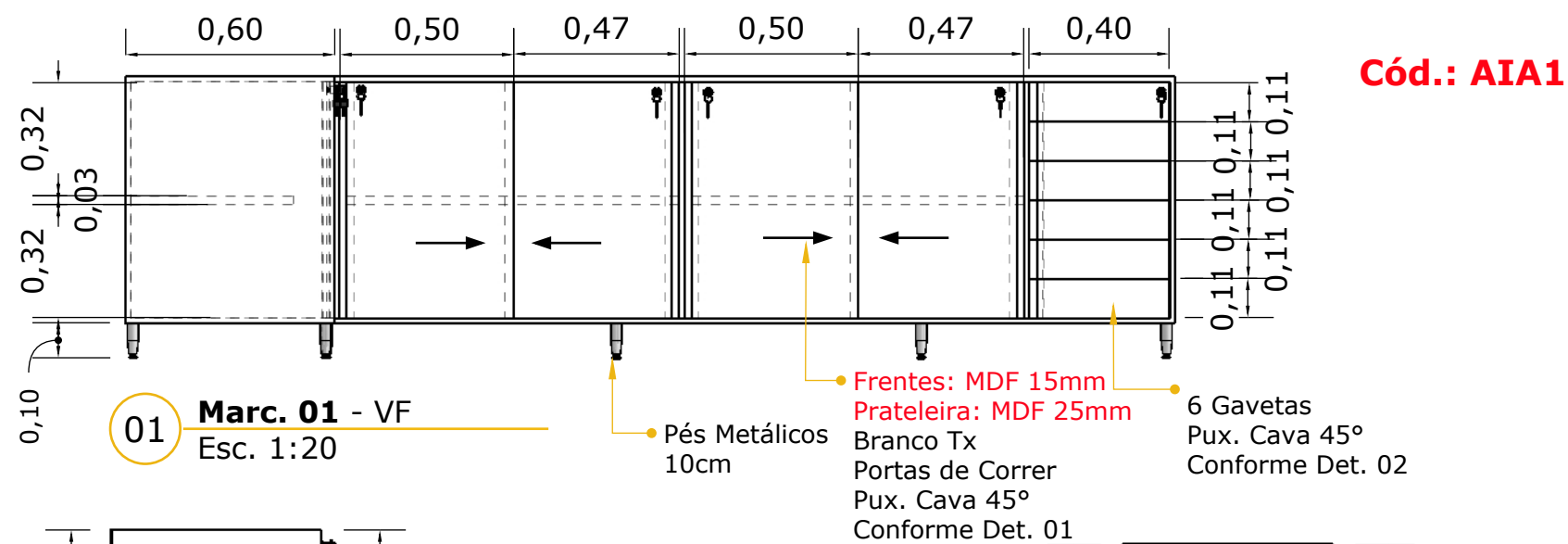

GRANITO CINZA ANDORINHA
ESPESSURA: 0,05cm

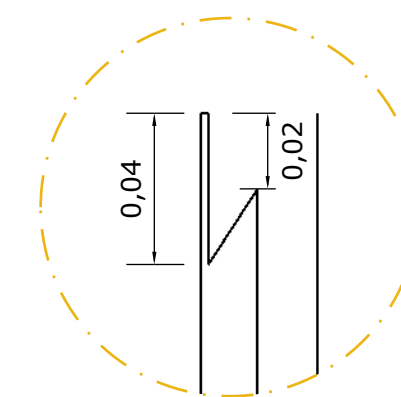
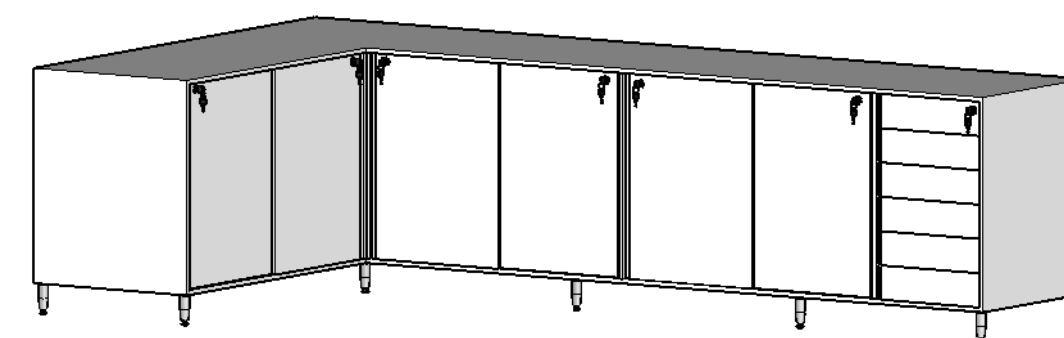
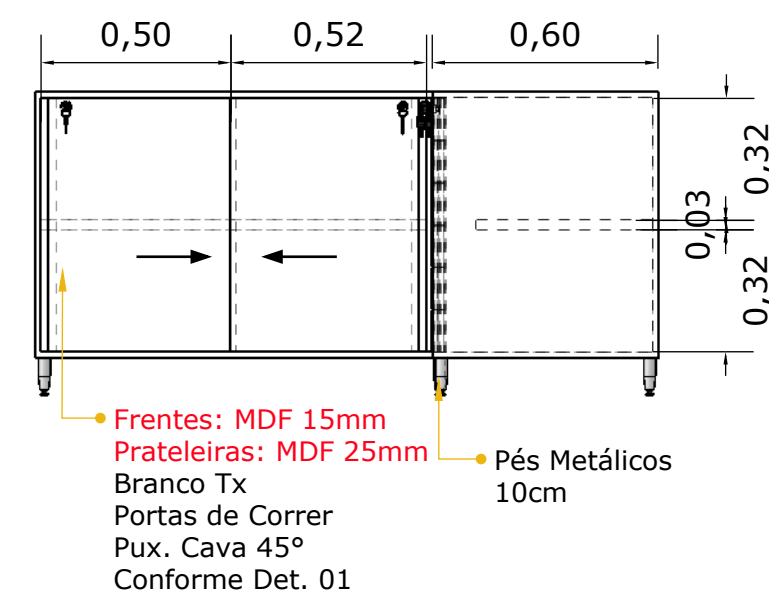
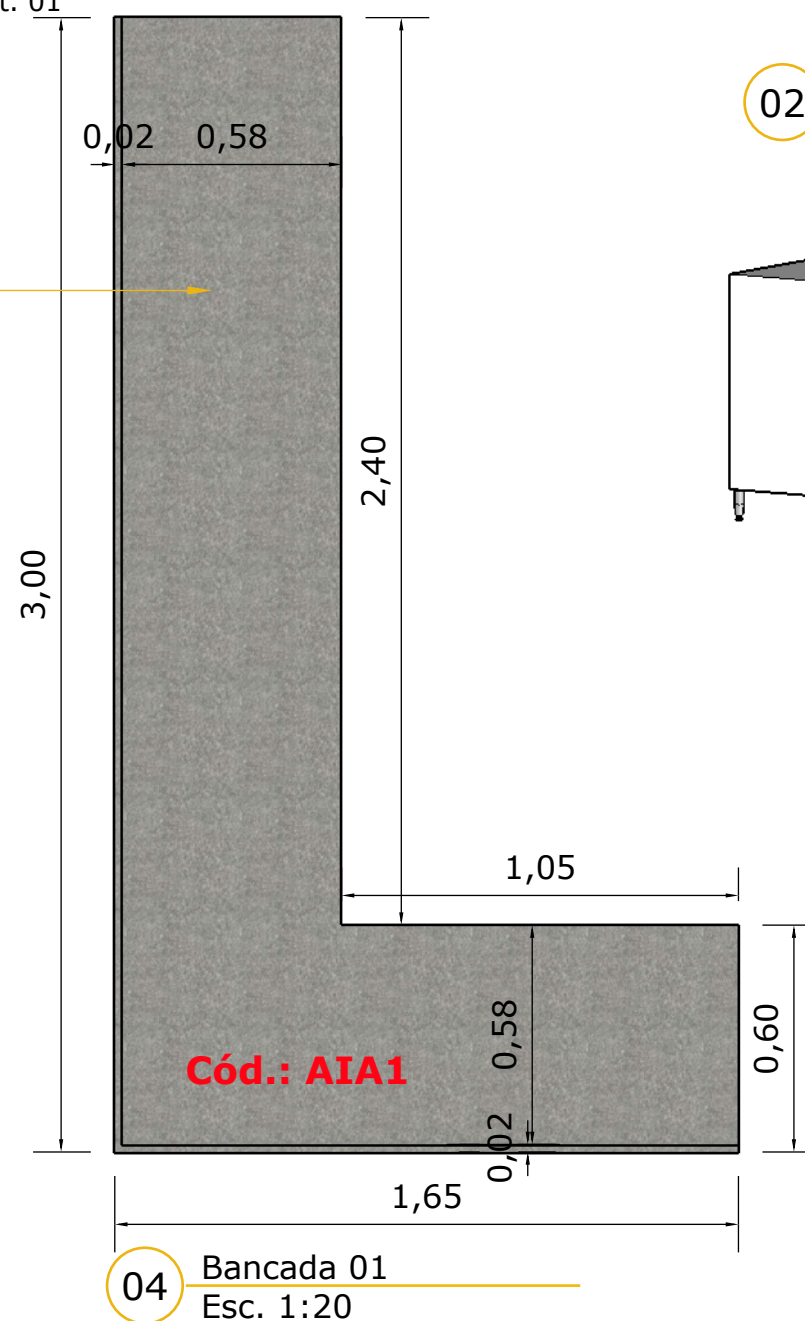

Det. 01 - Vista Superior
Cava 45° - Vertical
Esc. 1:2

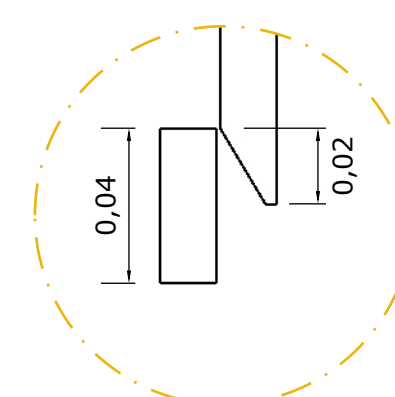

Det. 02 - Vista Superior
Cava 45° - Vertical
Esc. 1:2

OBS. Todo Móvel em MDF Ultra
Conferir Medidas IN LOCO

OBS. Todas as portas com fechadura

Cód.: AIL1

01 Marc. 02 - VF
Esc. 1:20

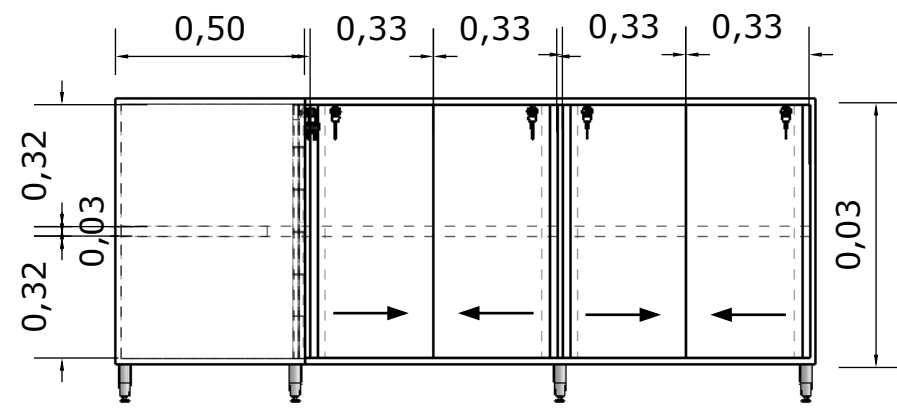

6 Gavetas
Pux. Cava 45°
Conforme Det. 02

Porta de Abrir
Pux. Cava 45°
Conforme Det. 02

Pés Metálicos
10cm

Frentes: MDF 15mm
Prateleiras: MDF 25mm
Branco Tx
Portas de Correr
Pux. Cava 45°
Conforme Det. 01

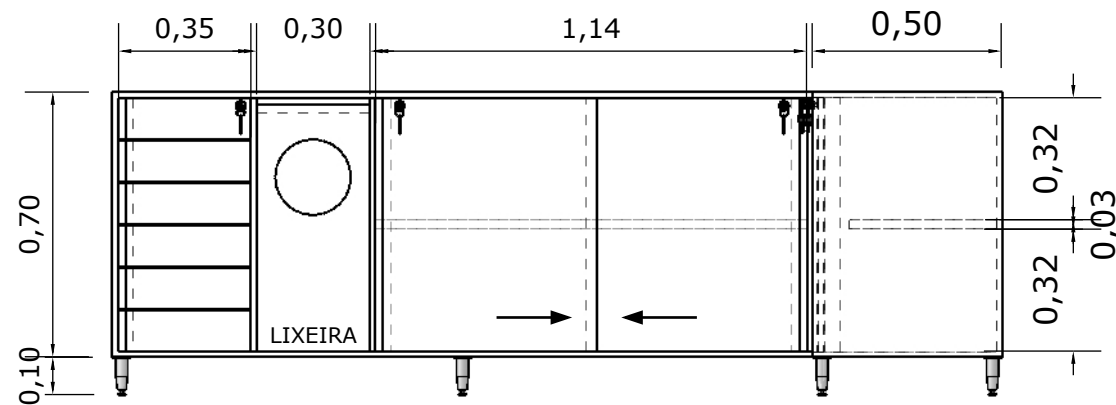
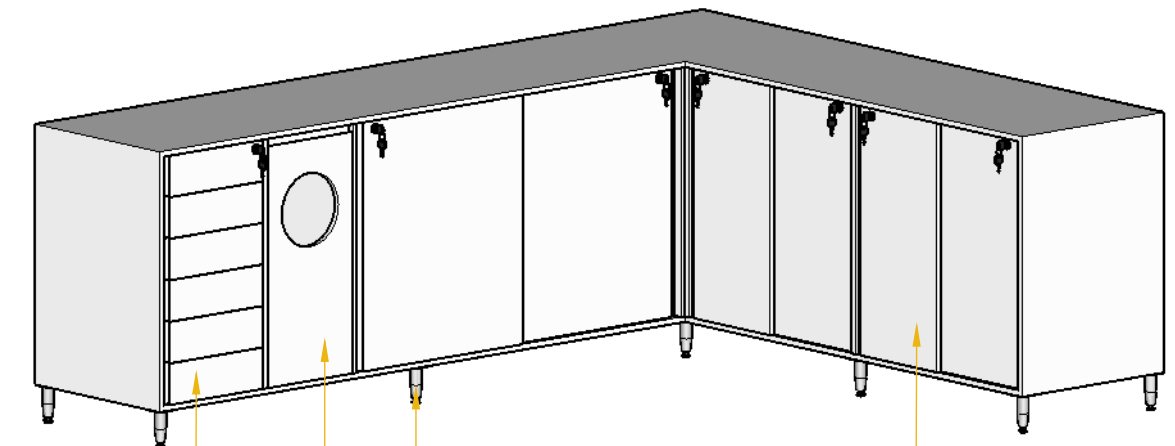

02 Marc. 02 - VL
Esc. 1:20

PEDRA EXISTENTE
CONFERIR MEDIDAS
IN LOCCO

03 Marc. 02 - VS
Esc. 1:20

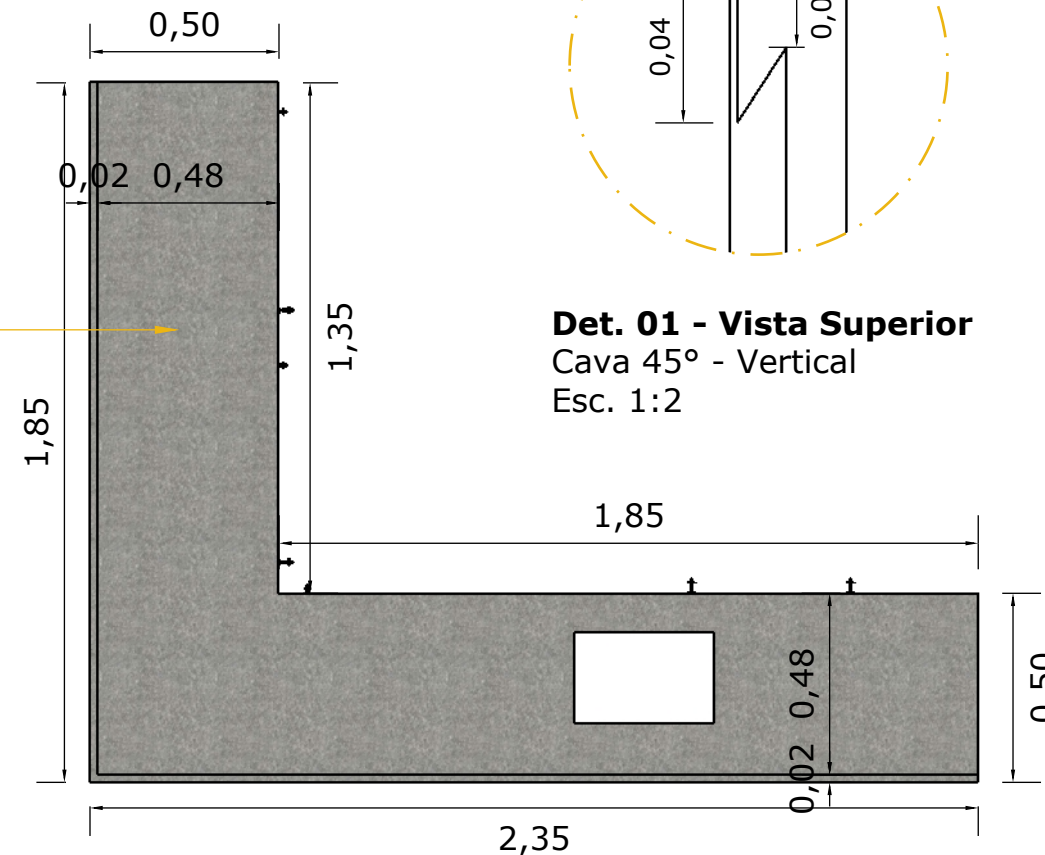
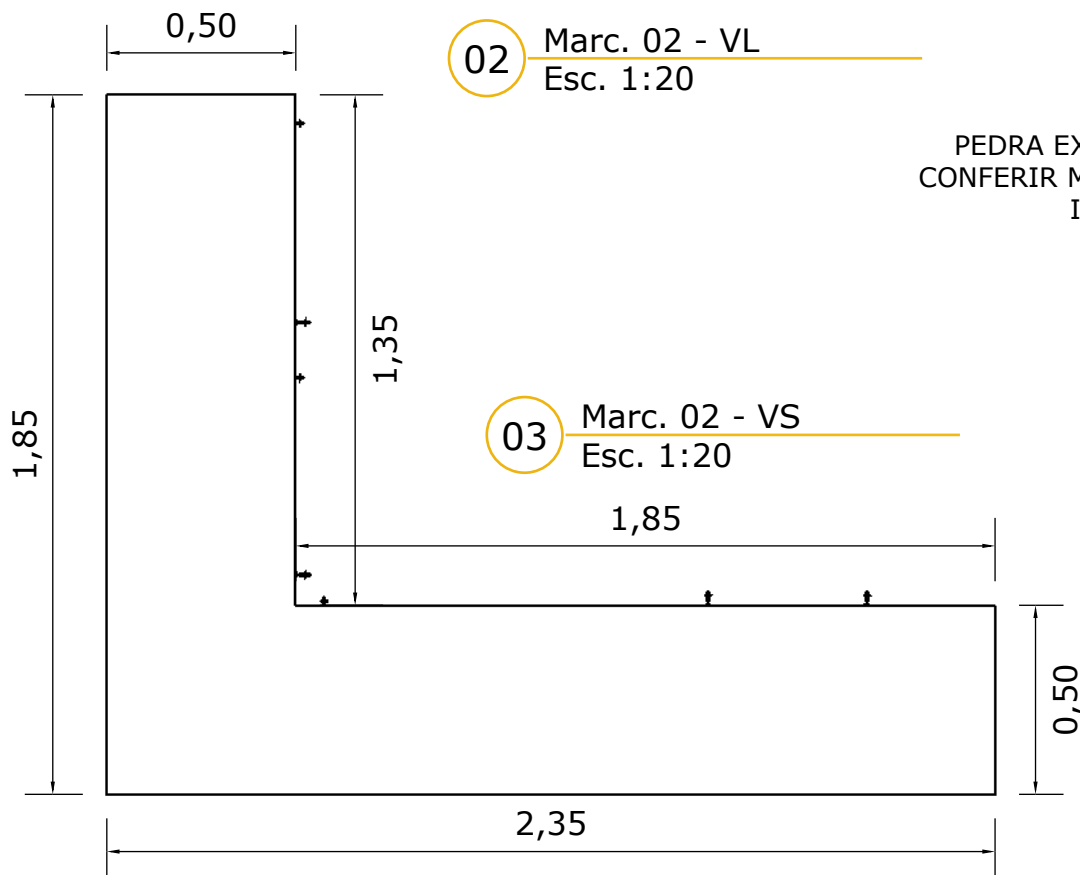

Det. 01 - Vista Superior
Cava 45° - Vertical
Esc. 1:2

Det. 02 - Vista Superior
Cava 45° - Vertical
Esc. 1:2

04 Bancada 02
Esc. 1:20

OBS. Todo Móvel em MDF Ultra
Conferir Medidas IN LOCO

OBS. Todas as portas com fechadura



Projeto de Interiores
Detalhamento de móvel

Desenho: Alanna Ferreira
Data: 7, dezembro 2022

Supervisora: Beatriz
Engenheira

Projeto:
ODONTOLOGIA

Revisão:
Rev. 00

8/14

Cód.: AAA1

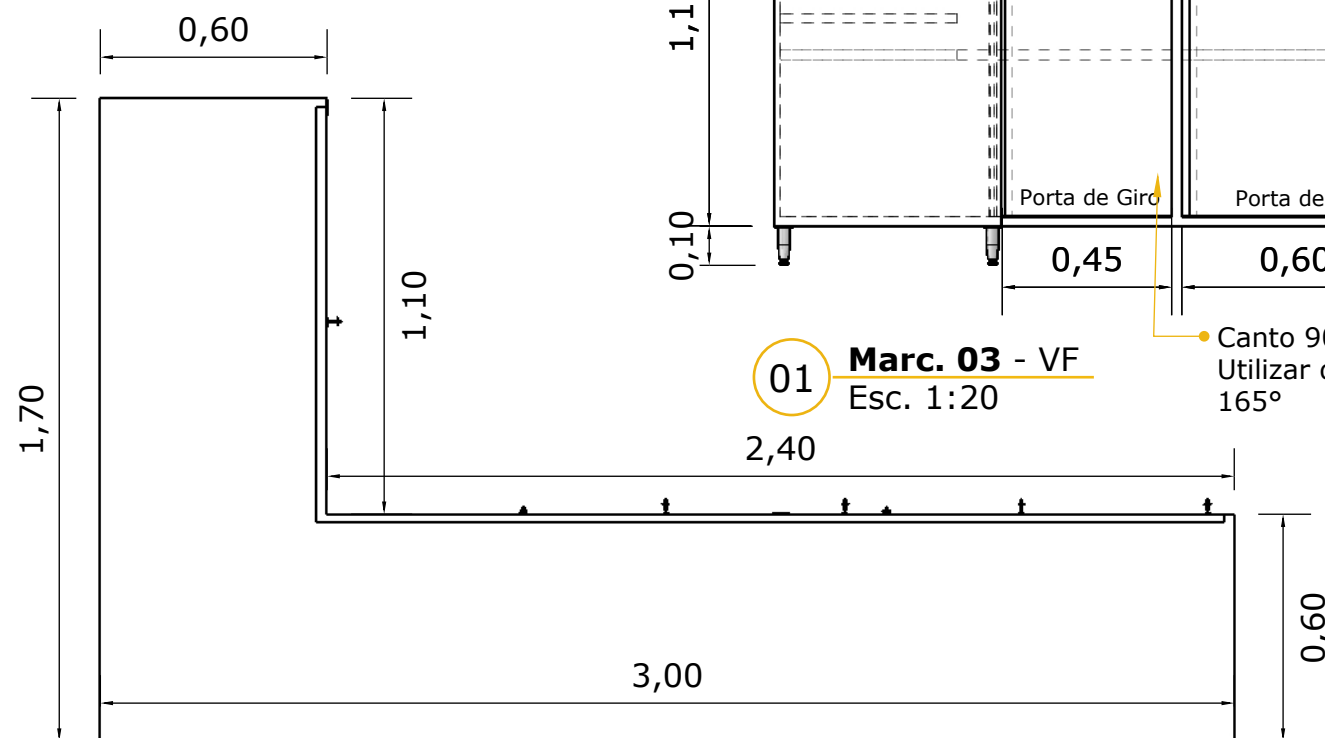
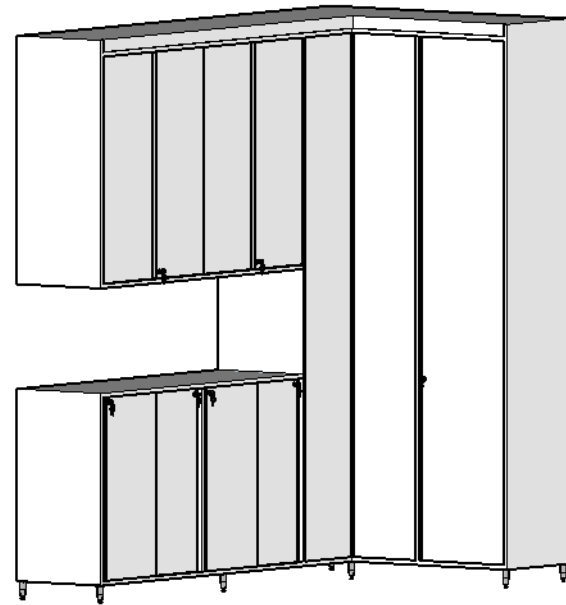

03 Marc. 03 - VS
Esc. 1:20

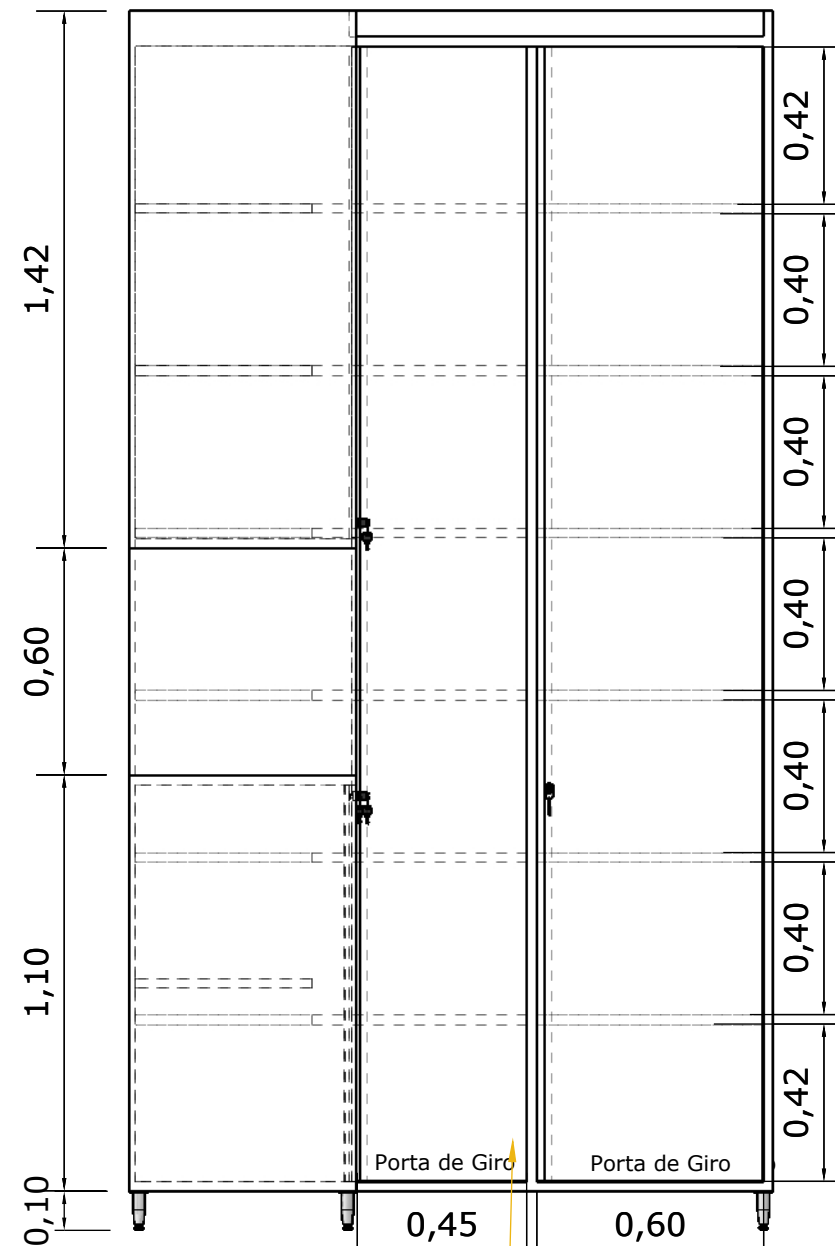

01 Marc. 03 - VF
Esc. 1:20

Canto 90° Graus
Utilizar dobradiças
165°

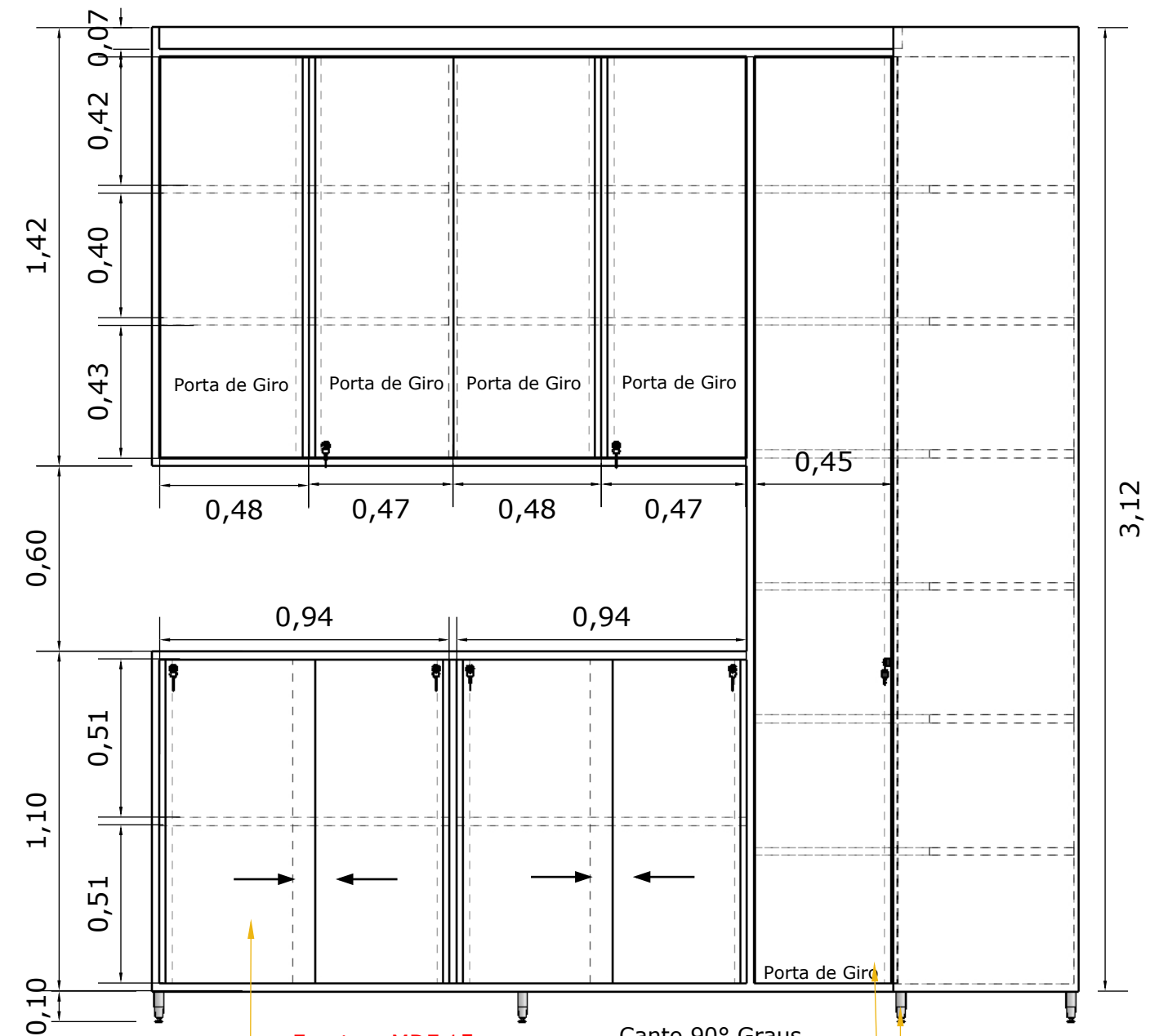

02 Marc. 03 - VL
Esc. 1:20

Frentes: MDF 15mm
Prateleiras: MDF 25mm
Branco Tx
Portas de Correr
Pux. Cava 45°
Conforme Det. 01

Canto 90° Graus
Utilizar dobradiças
165°

Pés Metálicos
10cm

Det. 01 - Vista Superior
Cava 45° - Vertical
Esc. 1:2

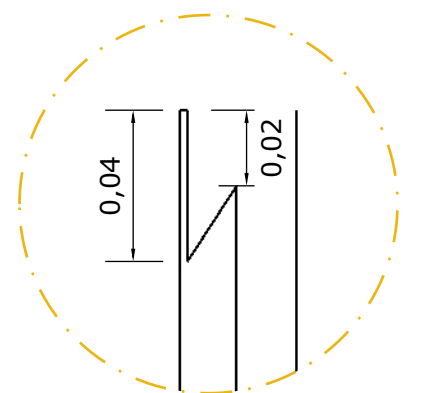

OBS. Todas as portas com fechadura

OBS. Todo Móvel em MDF Ultra
Conferir Medidas IN LOCO



Projeto de Interiores
Detalhamento de móvel

Desenho: Alanna Ferreira
Data: 7, dezembro 2022

Supervisora: Beatriz
Engenheira

Projeto:
ODONTOLOGIA

Revisão:
Rev. 00

9/14

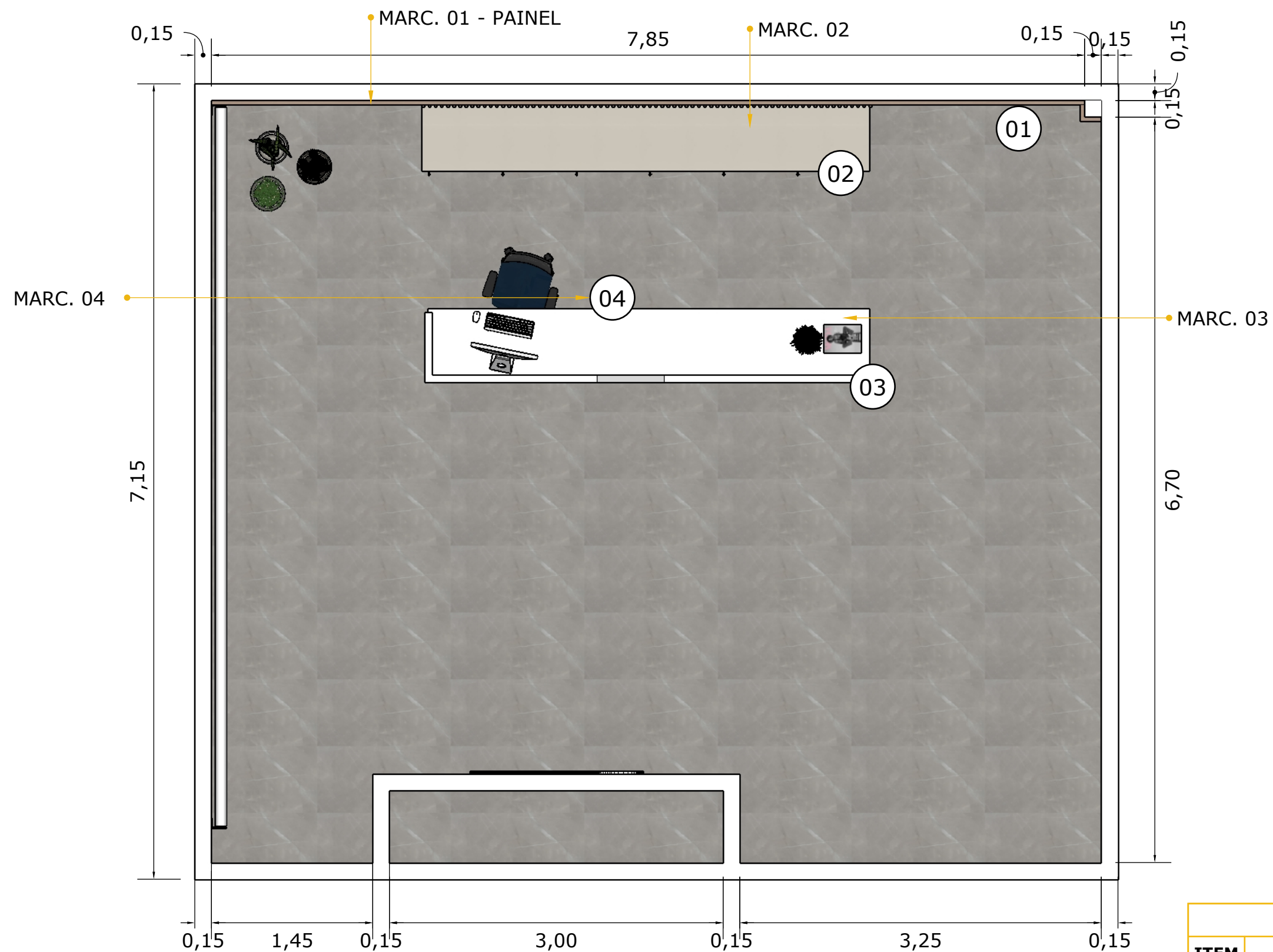

01 PLANTA LAYOUT
Esc.: 1:40

Conferir Medidas IN LOCO

LEGENDA		
ITEM	TIPO	DESCRIÇÃO
01	MARC. 01	Painel Ripado
02	MARC. 02	Gaveteiro de Arquivo
03	MARC. 03	Balcão de Atendimento
04	MARC. 04	2 - Gaveteiros

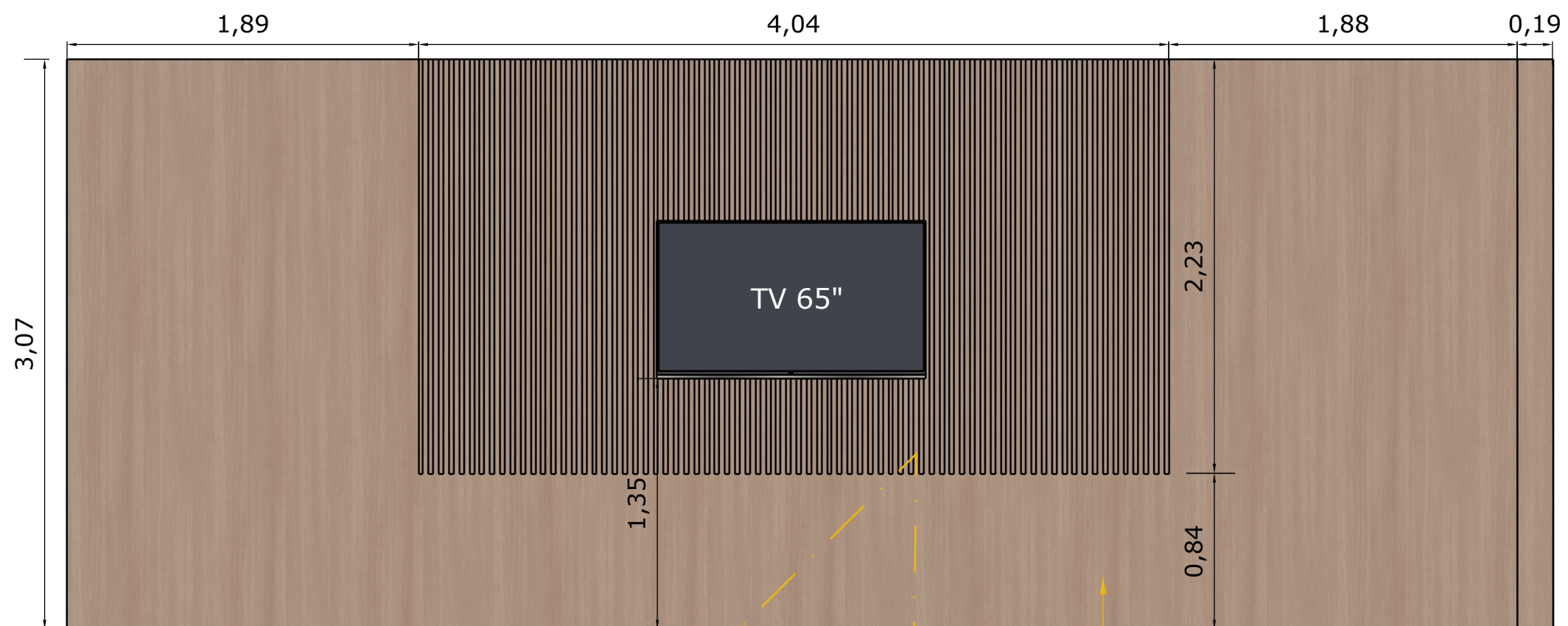

Cód.: PRR2

01 Marc. 01 - VF
Esc.: 1:30

Painel Ripado
MDF 15mm Carvalho Avelã - Duratex

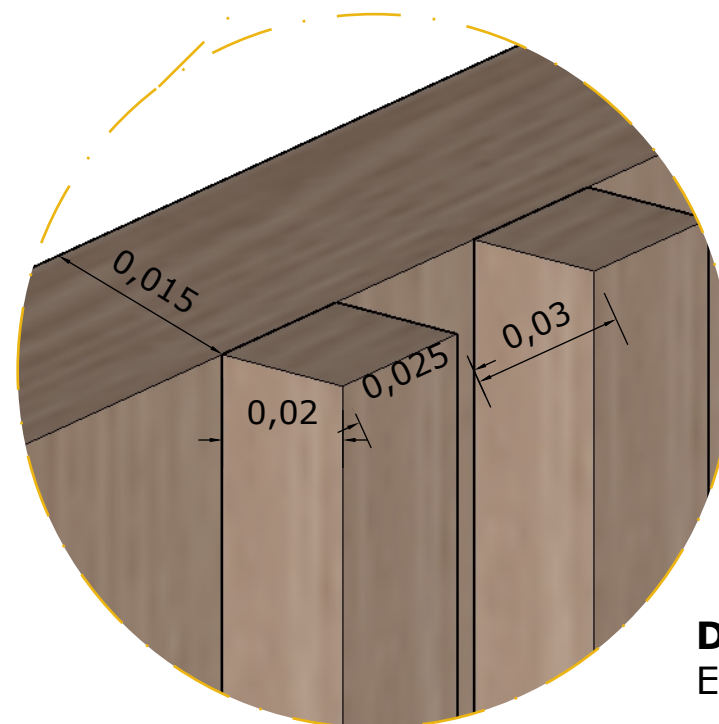

DET. RIPADO
Esc.: 1:1

Conferir Medidas IN LOCO



Projeto de Interiores
Detalhamento de móvel

Desenho: Alanna Ferreira
Data: 7, dezembro 2022

Supervisora: Beatriz
Engenheira

Projeto:
ODONTOLOGIA

Revisão:
Rev. 00

11/14

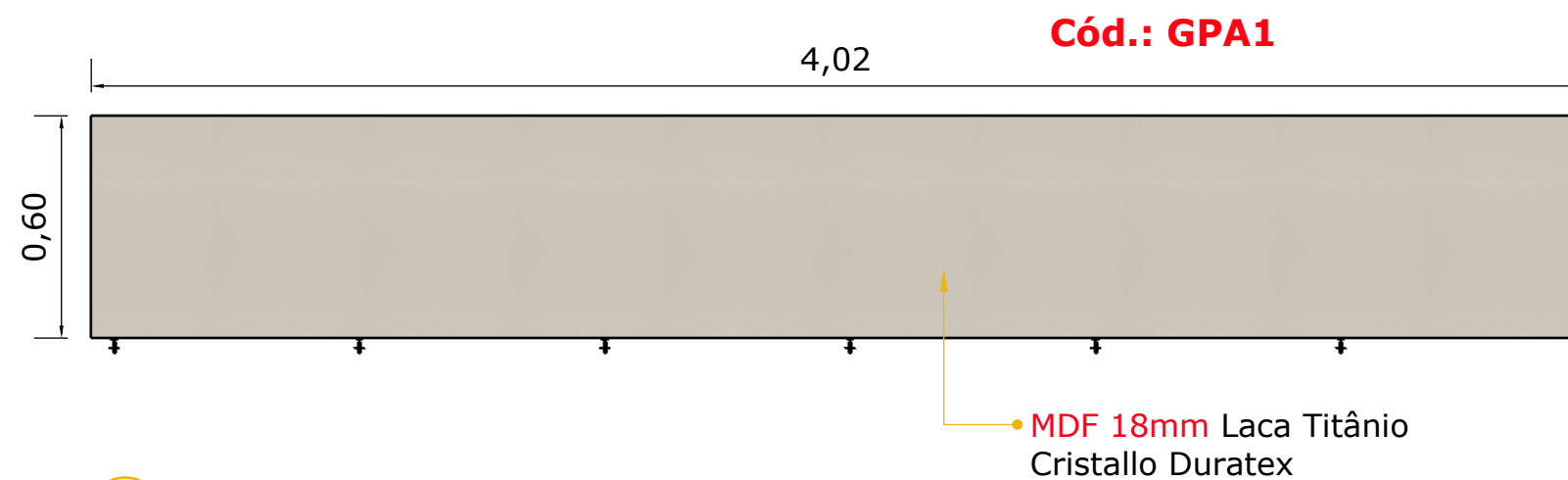

01 **Marc. 02 - Vista Superior**
Esc.: 1:20

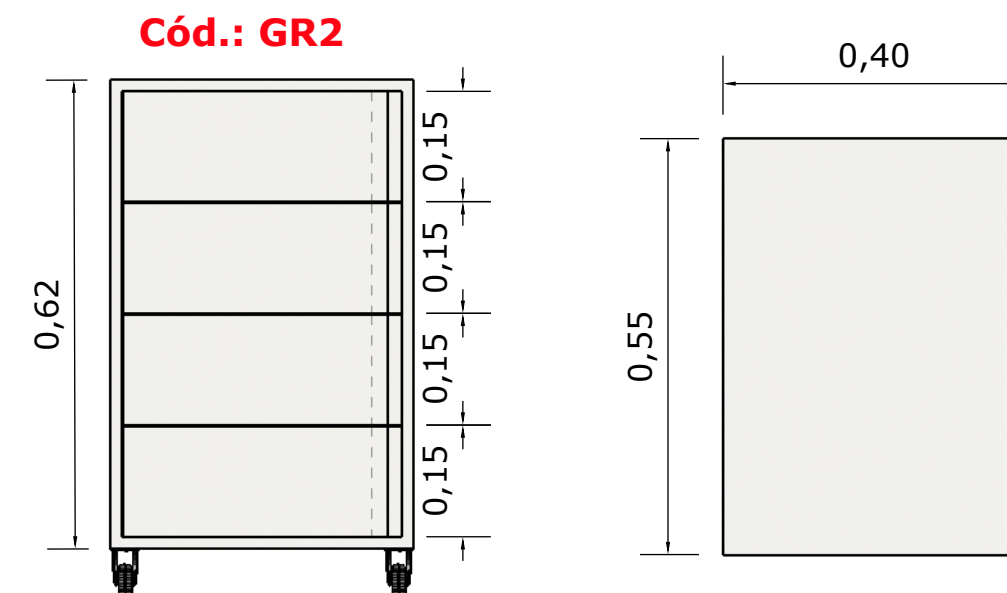

03 **Marc. 04 - Vista Frontal**
Esc.: 1:10

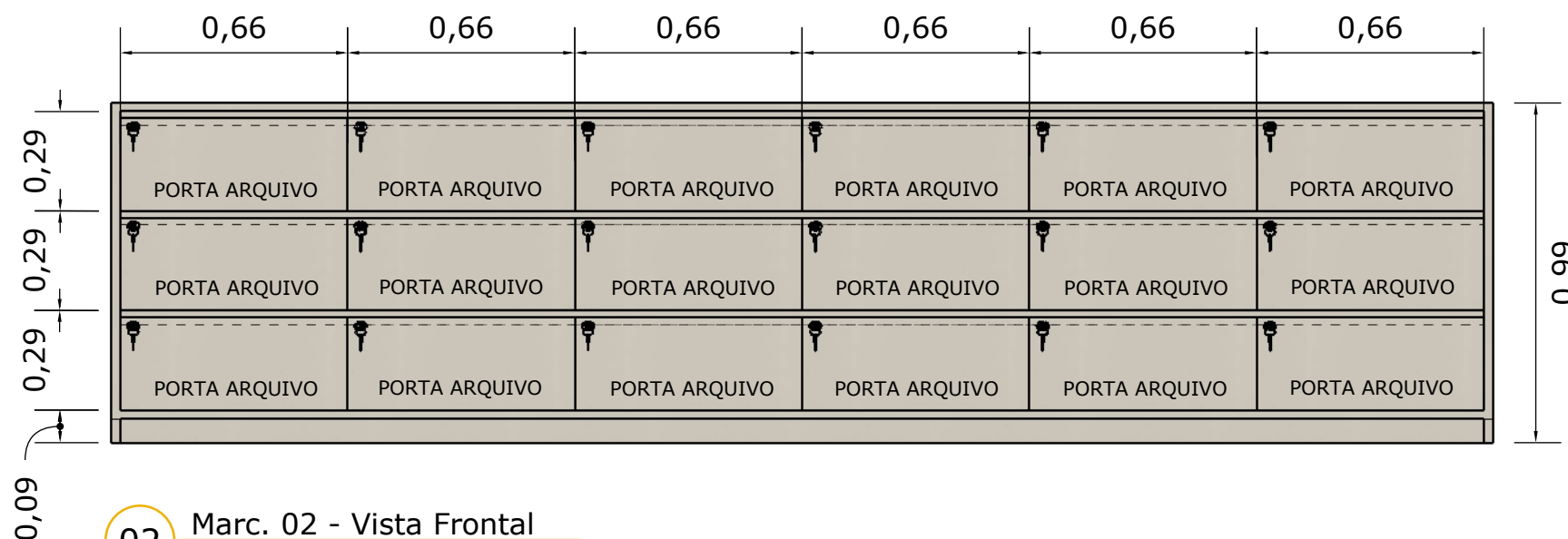

02 **Marc. 02 - Vista Frontal**
Esc.: 1:20

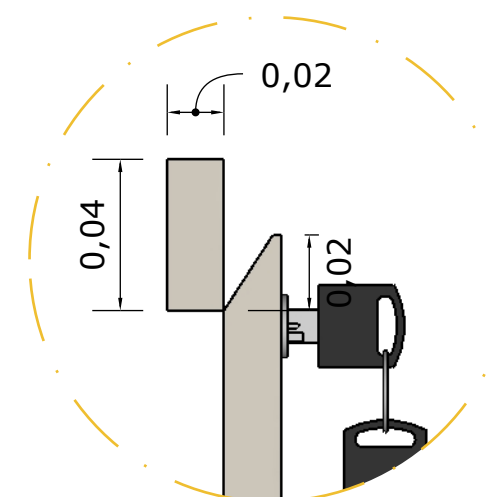
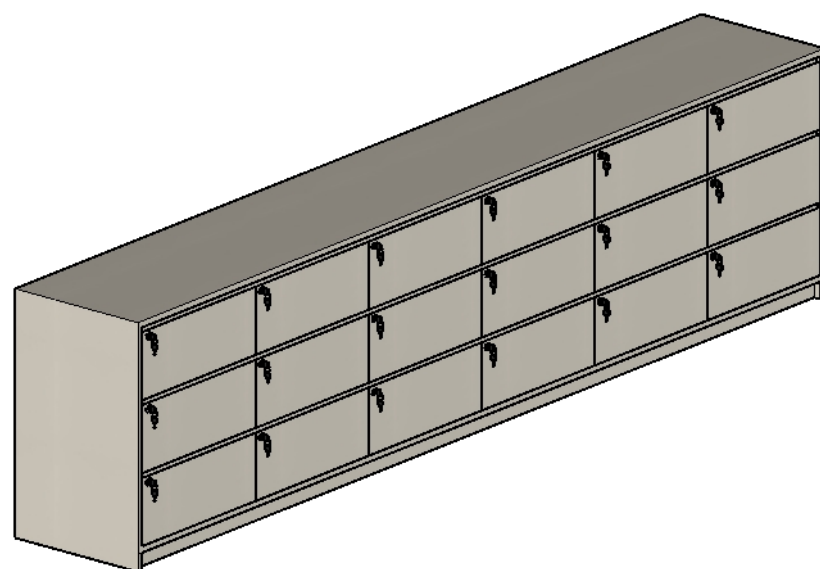

Det. 01 - Cava 45°
Horizontal e Vertical
Esc.: 1:2

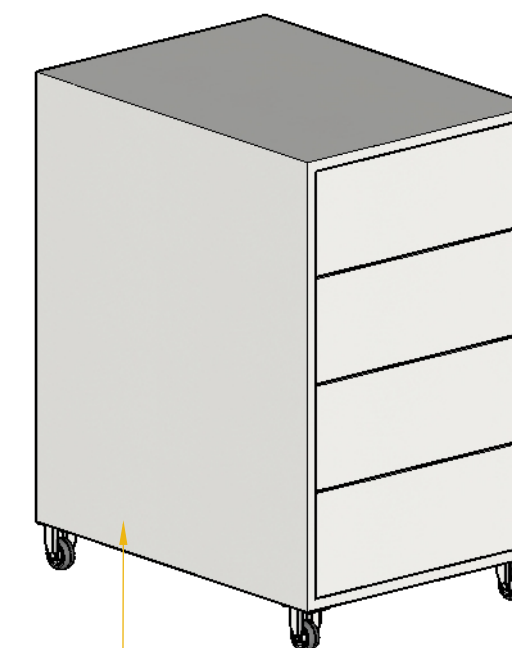

Corpo em Laca Diamante
Cristallo Duratex
MDF 18mm

OBS. Todas as gavetas com fechaduras
Conferir Medidas IN LOCO

Cód.: BA2

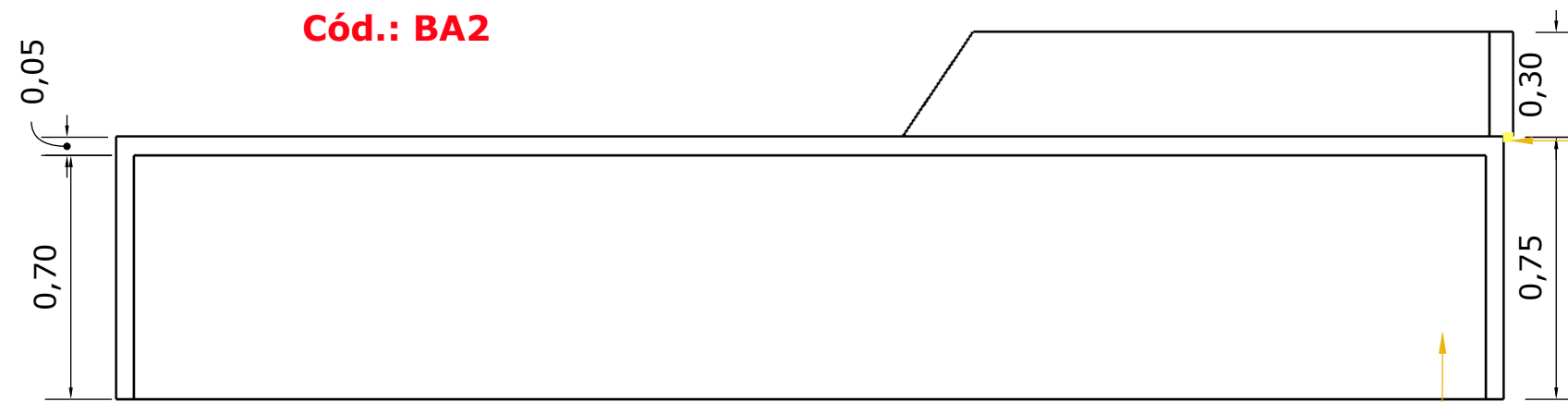

Fazer cava de acabamento para
Fita de Led, Luz Neutra
4000k

01 Marc. 03 - Vista de Trás
Esc.: 1:20

Tampo engrossado de 51mm, sendo,
02 peças de Mdf de 18mm laca e no
MDF de 15mm cru.

MDF 18mm Laca Diamante
Cristallo Duratex

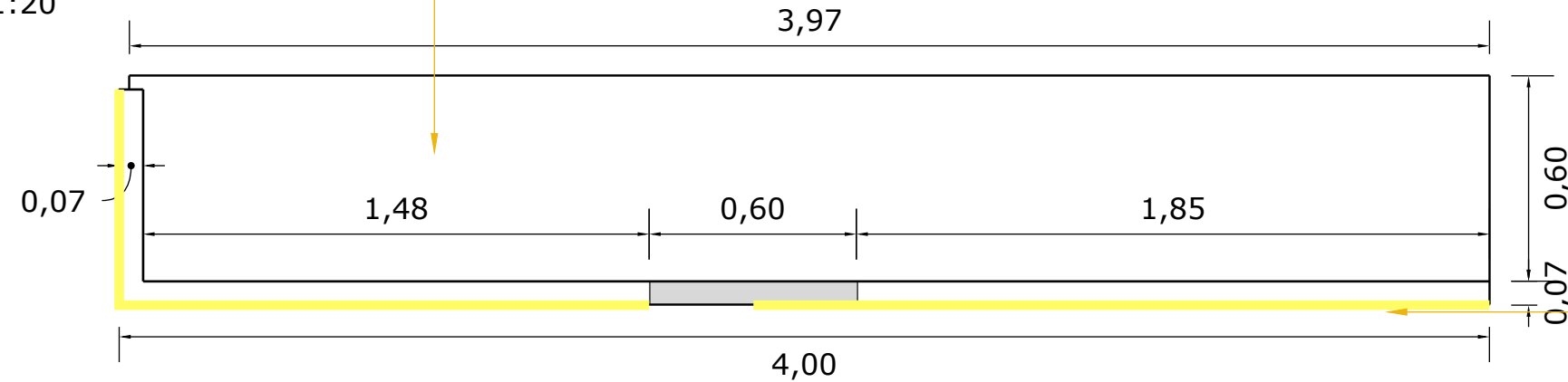

Fazer cava de acabamento para
Fita de Led, Luz Neutra
4000k

02 Marc. 03 - Vista Superior
Esc.: 1:20

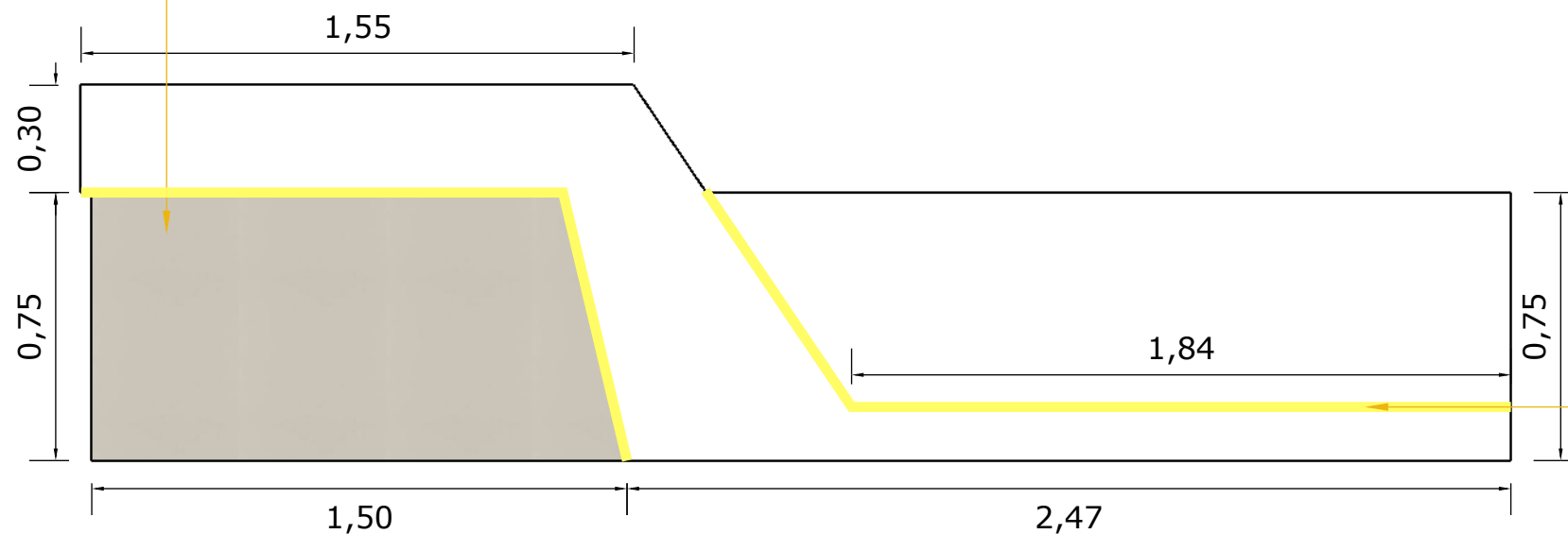

Fazer cava de acabamento para
Fita de Led, Luz Neutra
4000k

03 Marc. 03 - Vista Frontal
Esc.: 1:20

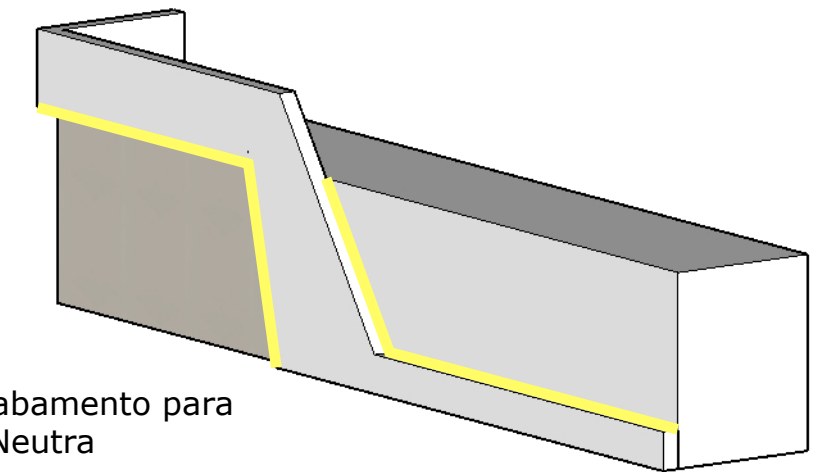

Conferir Medidas IN LOCO
OBS. Todas as gavetas com fechaduras



Conferir Medidas IN LOCO

OBS. Todas as gavetas com fechaduras



Projeto de Interiores

Detalhamento de móvel

Desenho: Alanna Ferreira
Data: 7, dezembro 2022

Supervisora: Beatriz
Engenheira

Projeto:

ODONTOLOGIA

Revisão:

Rev. 00

14/14